

E865 OWNER'S MANUAL CONTENTS

1. INTRODUCTION	2
2. SAFETY PRECAUTIONS	3
3. LIST OF PARTS	7
4. ASSEMBLE THE PRODUCT	9
STEP 1 Separate the Product from the Packaging	9
STEP 2 Assemble the Pedestal.....	10
STEP 3 Install the Upper Cover.....	11
STEP 4 Install Stride Linkages and Footplate Carriages.	11
STEP 5 Install Left/Right Supports	13
STEP 6 Secure the Rail Base Cover	14
STEP 7 Move the Unit into Place	15
STEP 8 Level the Unit	16
STEP 9 Ground Wire Installation	17
STEP 10 Beware of Moving Parts	17
5. UNDERSTAND THE E865 DISPLAY	18
DISPLAY Overview	18
DISPLAY Specifications	19
DISPLAY Windows	19
DISPLAY Keys	19
6. OPERATE THE PRODUCT	21
OPERATION Quick Start	21
OPERATION Start a Workout Program	21
OPERATION Display	22
OPERATION Cool Down	23
OPERATION Workout Programs	23
OPERATION User Preferences and Component Versions.....	26
7. ABOUT HEART RATE DETECTION	27
HEART RATE Telemetry	27
HEART RATE Contact	27
8. GUIDELINES FOR EXERCISE	28
9. ACCESSORIES	29
ACCESSORIES Entertainment Cap	30
10. MAINTENANCE	31
MAINTENANCE Messages	31
MAINTENANCE Lubrication	31
MAINTENANCE Lubrication Procedure	32
MAINTENANCE Cleaning the Glide Rail	33
MAINTENANCE Schedule	34
MAINTENANCE Task List (Elliptical Trainers)	35
MAINTENANCE One-Year Maintenance Log	36
MAINTENANCE Electronics Block Diagram	37

1. INTRODUCTION

Congratulations on your purchase of one of the finest exercise products on the market today, the SportsArt E865 elliptical trainer. Constructed of high quality materials and designed for years of reliable usage, this product was made to become an integral part of your commercial fitness venue.

Before this product is assembled or operated, we recommend that you familiarize yourself with this manual. Understanding the correct methods of assembly and operation will help ensure that exercisers obtain their fitness goals safely and successfully.

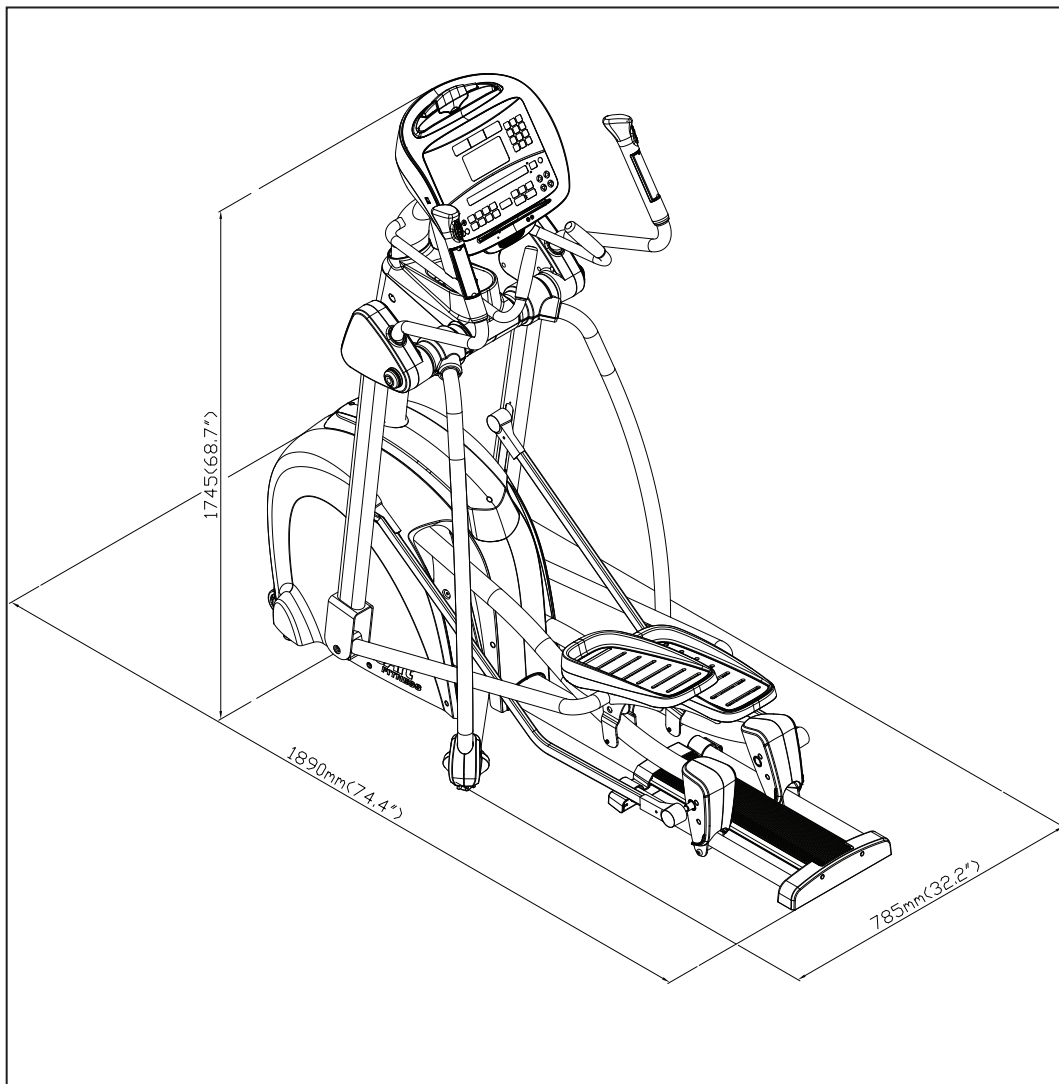

2. SAFETY PRECAUTIONS

Your SportsArt elliptical trainer was designed and built for optimum safety. However certain precautions apply whenever you use your elliptical trainer.

Please read the entire manual before assembly and operation. Also, please note the following safety precautions:

- Please read the instructions carefully and install the elliptical trainer as instructed.
- Assemble and operate the elliptical trainer on a solid, level surface. DO NOT use outdoors or near water.
- Never allow children on or near the elliptical trainer.
- Check the elliptical trainer before every use. Make sure all parts are assembled, and all fasteners are tightened. DO NOT use the elliptical trainer if the unit is disassembled in any way.
- Keep your hands away from moving parts.
- Wear proper workout clothing; DO NOT wear loose clothing. DO NOT wear shoes with leather soles or high heels. Tie all long hair back. DO NOT go barefoot on this product.
- Be careful when mounting and dismounting the unit.
- The elliptical trainer may or may not stop immediately if an object becomes caught or impedes normal motion.
- DO NOT use any accessories that are not specifically recommended by the manufacturer. Such parts might cause injuries or cause the unit to fail.
- Close supervision is necessary when this elliptical trainer is used by, on, or near children, invalids, or disabled persons.
- Use this elliptical trainer only for its intended use as described in this manual.
- Never operate this elliptical trainer if it has been damaged in any way. If it is not working properly, or has been dropped or damaged, contact your dealer.
- Keep all air ventilation areas free of blockage.
- Never drop or insert any object into any opening.
- DO NOT operate where aerosol (spray) products are being used or where oxygen is being administered.
- The general user weight limit for this elliptical trainer is 227kg (500lb). Note that at resistance level 40 this product meets standards for users of up to 150kg (330lb).
- This elliptical trainer is not intended for use by persons (including children) with reduced physical, sensory or mental capabilities, or lack of experience and knowledge, unless they have been given supervision or instruction concerning use of this bike by a person responsible for their safety.
- Children should be supervised to ensure that they do not play with the elliptical trainer.

2. SAFETY PRECAUTIONS (CONTINUED)

Caution

If you feel any pain or abnormal sensation, STOP YOUR WORKOUT and consult your physician immediately. Work within your recommended exercise level. DO NOT work to exhaustion.

Before beginning any exercise program, you should consult with your doctor. It is recommended that you undergo a complete physical examination.

Note: This equipment has been tested and found to comply with the limits for a Class B digital device, pursuant to part 15 of the FCC Rules. These limits are designed to provide reasonable protection against harmful interference in a residential installation. This equipment generates, uses, and can radiate radio frequency energy and, if not installed and used in accordance with the instructions, may cause harmful interference to radio communications. However, there is no guarantee that interference will not occur in a particular installation. If the user desires to correct such interference, it is at the user's own expense.

Warning

Heart rate monitoring systems may be inaccurate. Over exercise may result in serious injury or death. If you feel faint, stop exercise immediately and consult a medical physician.

2. CONSIGNES DE SÉCURITÉ

Votre elliptique SportsArt a été conçu et fabriqué afin d'assurer une sécurité optimale. Cependant certaines précautions s'appliquent chaque fois que vous utilisez votre elliptique de course

Lisez entièrement le manuel avant l'assemblage et l'utilisation. Veuillez aussi noter les consignes de sécurité suivantes:

- Veuillez lire attentivement les instructions et installer l'elliptique selon les instructions.
- Assemblez et faites fonctionner l'elliptique sur une surface solide et plane; NE PAS l'utiliser à l'extérieur ou près de l'eau
- En aucun cas, ne laissez des enfants à proximité ou sur l'elliptique.
- Vérifiez l' elliptique de course avant chaque utilisation. Assurez-vous que toutes les pièces sont assemblées et que tous les éléments de fixation sont serrés.
- NE PAS utiliser l' elliptique si l'appareil est démonté de quelque façon.
- Gardez vos mains loin des pièces mobiles.
- Portez des vêtements d'entraînement appropriés; NE PORTEZ PAS de vêtements amples. NE PORTEZ PAS de chaussures à semelles en cuir ou à talons hauts.
- Attachez les cheveux longs. Ne marchez pas pieds nus sur l'appareil.
- Soyez prudent lors du montage et démontage de l'appareil.
- L' elliptique peut s'arrêter ou ne s'arrêter pas immédiatement si quelque chose obstacle le mouvement.
- NE PAS utiliser d'accessoire non spécifiquement recommandé par le fabricant. Car cela pourraient provoquer des blessures ou entraîner une panne de l'appareil.
- Une surveillance étroite est nécessaire quand l'elliptique est utilisé par ou à proximité d'enfants, de malades ou de personnes handicapées.
- Utilisez l' elliptique uniquement pour l'usage prévu dans ce manuel.
- N'utilisez jamais l' elliptique s'il a été endommagé de quelque façon que ce soit. S'il ne fonctionne pas correctement, ou s'il est tombé ou endommagé, contactez votre vendeur.
- Veillez à ce qu'aucun orifice de ventilation ne soit obstrué.
- Ne faites jamais tomber ou n'insérez jamais d'objet dans les orifices.
- NE PAS l'utiliser là où des produits aérosols (vaporisés) sont utilisés ou lorsque de l'oxygène est administré.

2. CONSIGNES DE SÉCURITÉ (SUITE)

- La limite de poids de l'utilisateur pour cet elliptique est de 227 kg (500 lb.). Remarquez que la résistance de 20 convient jusqu'à 150 kg (330 lb.).
- Cet elliptique n'est pas destiné à être utilisé par des personnes (y compris des enfants) dont les capacités physiques, sensorielles ou mentales sont réduites ou qui ne disposent pas de l'expérience ou du savoir nécessaires, sauf si celles-ci ont au préalable été formées eu égard à l'utilisation de cet elliptique par une personne responsable de leur sécurité.
- Les enfants doivent être encadrés afin d'empêcher qu'ils ne jouent avec l'elliptique.

ATTENTION

Si vous ressentez une douleur ou si vous avez une sensation anormale, **ARRÊTEZ VOTRE ENTRAÎNEMENT** et consultez immédiatement votre médecin. Entraînez-vous à votre niveau d'exercice recommandé. **NE PAS** s'entraîner jusqu'à l'épuisement.

Avant de commencer un programme d'exercice, vous devriez consulter votre médecin. Il est recommandé de faire un examen physique complet.

NE PAS monter sur l'étape plus haute. En maintenant sur les supports de stabilité, monter sur l'étape plus bas.

Remarque: Ce matériel a été testé et déclaré conforme aux normes des appareils numériques de Classe B, conformément à la partie 15 du Règlement de la FCC. Ces limites sont conçues pour offrir une protection raisonnable contre les interférences nuisibles dans une installation résidentielle. Cet appareil génère, utilise, et peut diffuser des signaux radioélectriques, et, s'il n'est pas installé et utilisé conformément aux instructions, peut provoquer des interférences nuisibles aux communications radio. Cependant, il n'y a aucune garantie que des interférences ne se produiront pas dans une installation particulière.

Si l'utilisateur désire corriger les interférences, ces corrections seront à la charge de l'utilisateur.

Dans ce manuel, les mots "gauche" et "droit" sont utilisés en référence aux pièces et au produit. Comme tels, les mots "gauche" et "droit" font respectivement référence aux côtés gauche et droit de l'exerciseur. De même pour plus de concision, le mot "vis" est utilisé dans certains cas où des rondelles, des vis et autres matériels sont associés.

Si vous êtes une personne de langue française en Amérique du Nord, s'il vous plaît placer l'autocollant figurant dans le manuel du propriétaire sur le produit comme indiqué. Les clients dans d'autres pays ne recevront pas l'autocollant.

3. LIST OF PARTS

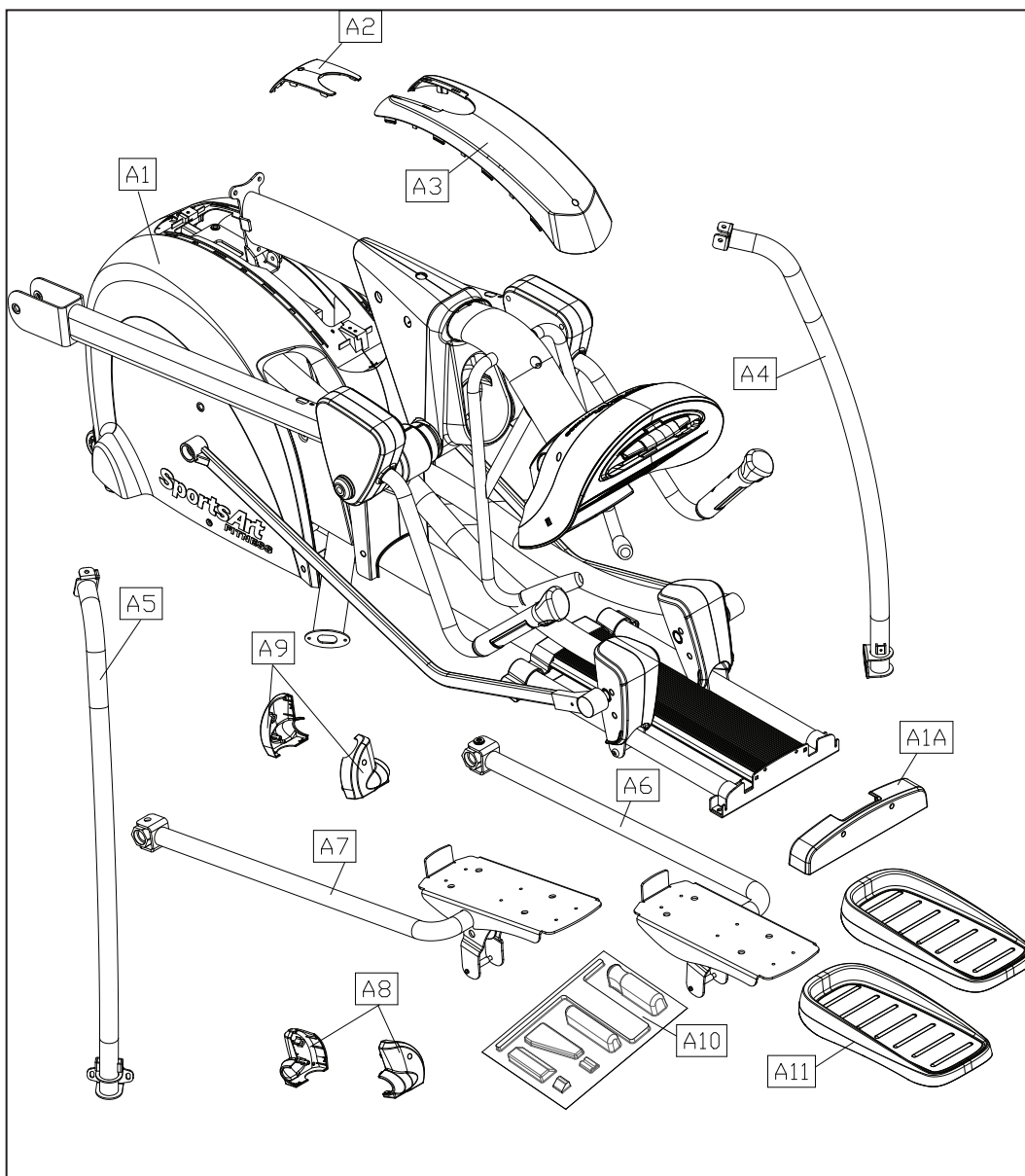

Assembly Parts					
No.	Name	Qty.	No.	Name	Qty.
A1	Main body	1	A6	Left footplate assembly	1
A1A	Rail base cover	1	A7	Right footplate assembly	1
A2	Small cover	1	A8	Base covers for right support	1
A3	Upper cover	1	A9	Base covers for left support	1
A4	Right support	1	A10	Hardware kit	1
A5	Left support	1	A11	Foot pedals	2

Components in the Hardware Kit				
No.	Name	Qty.	Specification	Notes
33	Mushroom top Phillips screw	6	M4*L16	
34	Inner hex screw	3	M8*L20	
	Spring washer	3	M8	
	Serrated washer	3	D18*D8.5*t2.0	
	Cushion washer	3	D13*0.25	
35	Left/right adjustment rod cover	2		
36	Screw insert	4		
37	M10 nut cap	2		
38	Screw cap	2		
	L-shaped Allen wrench	1	M6	
	L-shaped Allen wrench	2	M4	
	Double open-end wrench	1	8*17	
	Double open-end wrench	1	13*19	
	T-shaped Allen wrench	1	M5	
	Screwdriver shank	1	Flat and Phillips	
	Screwdriver handle	1	green	

Components on the Product				
No.	Name	Qty.	Specification	Notes
41	Phillips screw		M5*P0.8*L10	
42	Mushroom top Phillips screw		M4*L16	
43	Inner hex screw		M8*L25	
	Spring washer		M8	
	Washer		D17*d8.3*t1.0	
44	Inner hex screw		M6*L15	
	Serrated washer		D20*d6.2*t2.0*19T	
45	Inner hex screw		5/16**L2-1/4 half	
	Seat roller washer		D17*d8*t2.0	
46	Roller axle			
	Flat washer		D21*d10.5*t2	
	Lock nut		M10	
47	PU sheath		D12*D8*L45	
	Axle		M5*L71	
	Flat washer		D10*d5.2*t1	
	Mushroom top inner hex screw		M5*6	

48	Mushroom top inner hex screw	M5*L20	
49	Mushroom top inner hex screw	M5*L20	
	Flat washer	D16*d6.3*t2	
	Lock nut	M5*P0.8	

4. ASSEMBLE THE PRODUCT

Follow instructions below to assemble this product. Note that in this manual the words “left” and “right” are used to refer to the product and its parts. As such, these designations correspond to the “left” and “right” sides of a person in position to exercise on this product. Also, for brevity, the word “screws” is used where screws, washers, and other hardware may be involved.

STEP 1 Separate the Product from the Packaging

Please follow instructions A through D to remove packaging material and to place the unit on top of the flattened cardboard.

- A. Remove the box top and the plastic sheet.
- B. Start working from above, first removing Styrofoam (2) above the unit.
- C. Lift Styrofoam (3) on both sides of the unit upward to remove it. Place parts aside separately.
- D. Lift the pedestal to remove Styrofoam (1) in the middle.

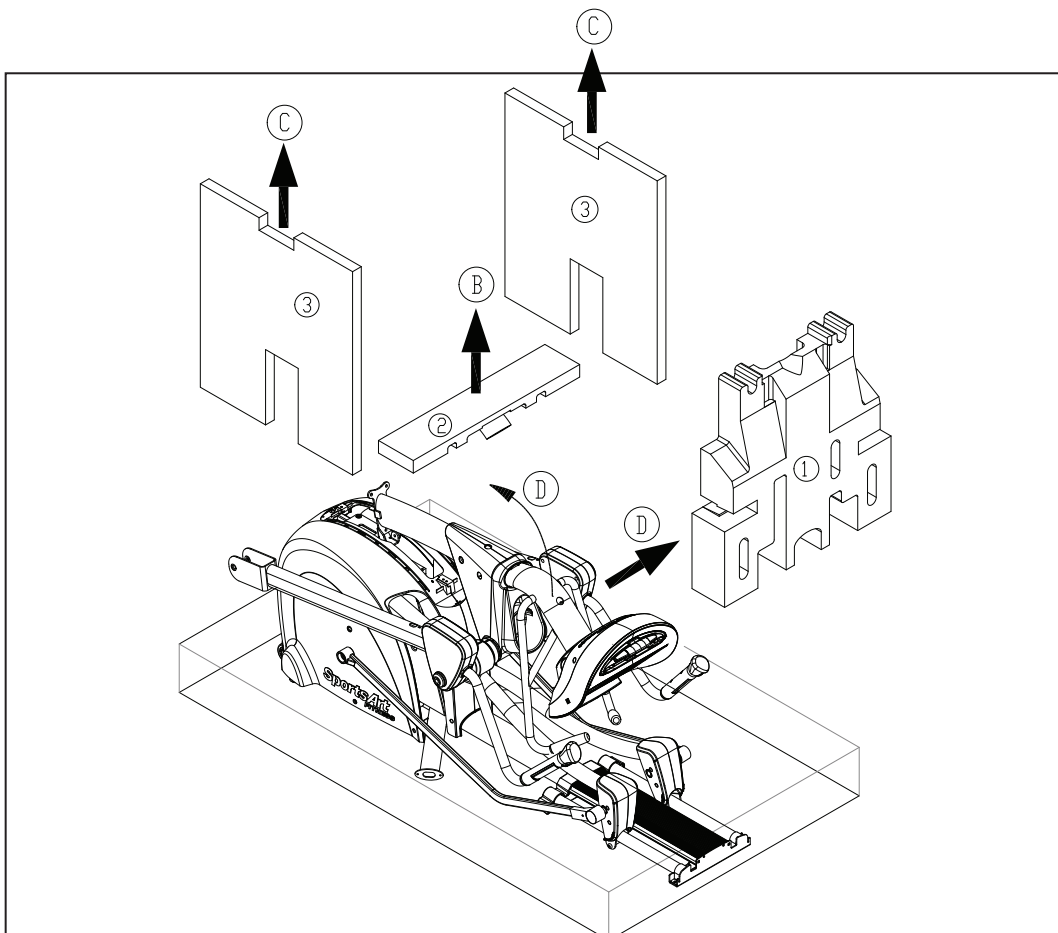

STEP 2 Assemble the Pedestal

Please follow instructions (a) through (b) to assemble the pedestal.

(a) Push the pedestal up to the vertical position while preventing the cable from getting pinched.

(b) Secure screws (34), first in area (A), then in area (B).

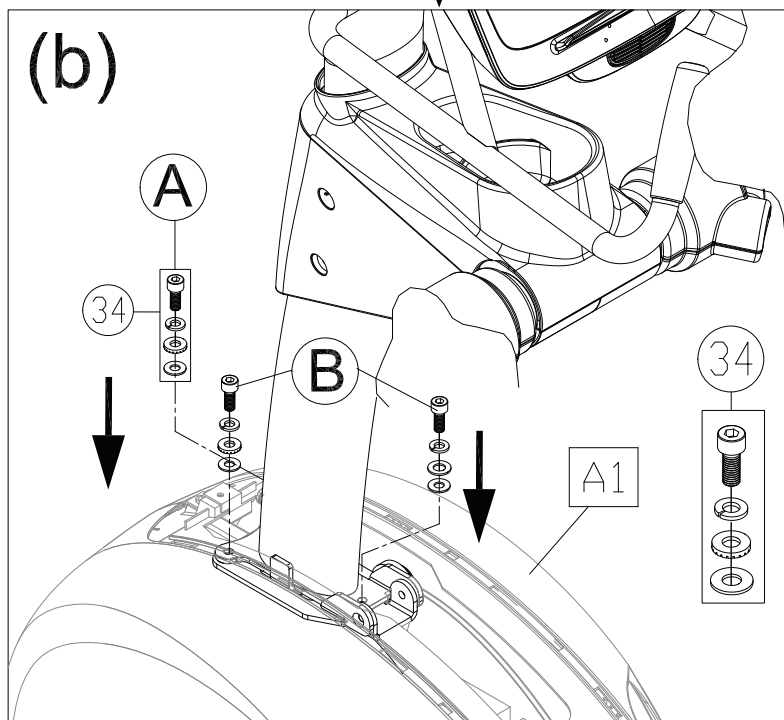
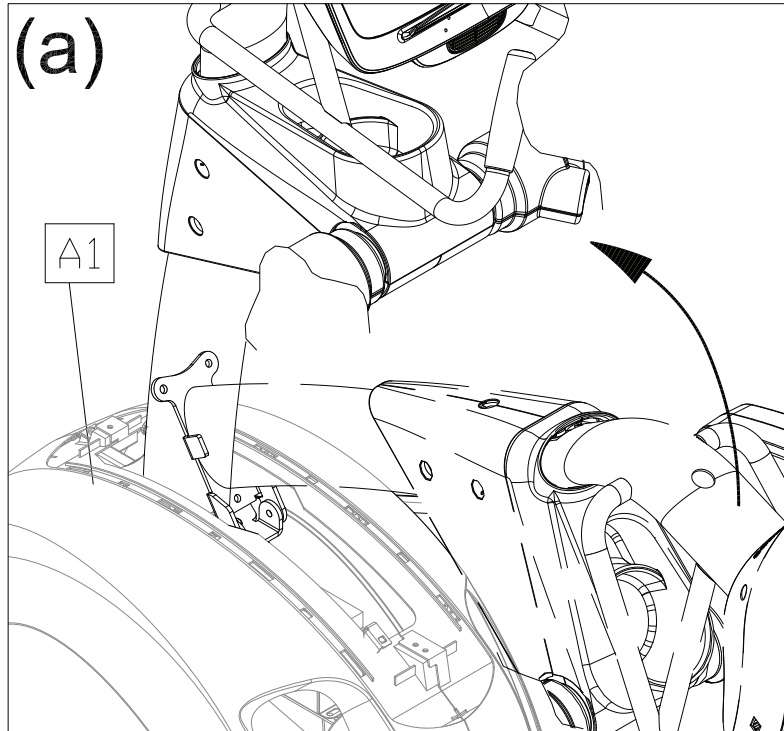

STEP 3 Install the Upper Cover

Please follow instructions (a) through (d) to install the upper cover.

(a) Slide the water guard up the pedestal. (This ring must be placed above the upper cover.)

(b) Install the upper cover and secure it with screw (33).

(c) Install the small cover (A2) and secure it with screw (33).

(d) Slide the water guard down the pedestal until it fits snugly against the covers.

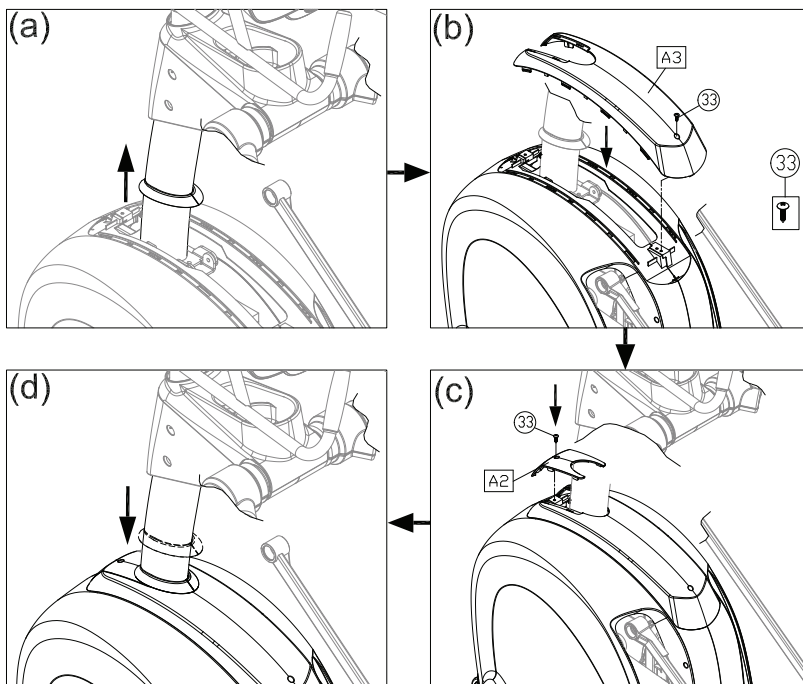

STEP 4 Install Stride Linkages and Footplate Carriages

Please follow steps (a) through (f) to install stride linkages and footplate carriages on both sides of the product.

(a) Remove bolts (45) from the bushing on the stride adjustment mechanism.

(b) Align the hole in the stride linkage with the bushing on the stride adjustment

mechanism, and press the stride linkage into place on the bushing. Secure the stride linkage with bolts (45). Then insert the stride linkage cover (35) into place. Follow the same procedure

on both sides.

(c) Remove bolts (46) from the vertical arms on both sides.

(d) Remove screws (47)(48)(49) from the left footplate carriage (A6).

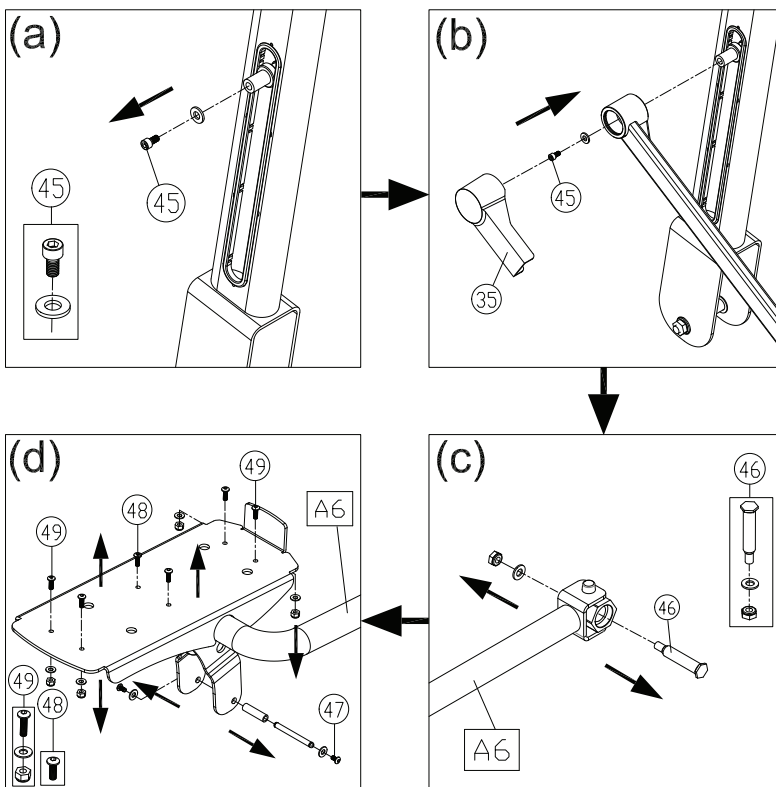

STEP 4 Install Linkages/Carriages (Continued)

(e) Insert the front of the footplate carriage into the vertical arm. Align it with the hole and use bolt (46) to secure it into place. Then insert caps (37, 38) into place.

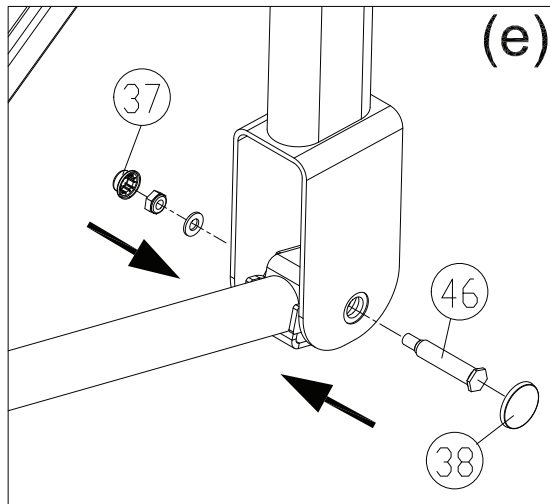

(f) First, lift up the pedal pad. Then, use screws (48)(49) to secure the footplate onto its mount on the pedal carriage. Once the foot plate assembly is secure and stable, press down the pedal pad onto the foot plate assembly. (Note: First use screws (48) to secure the footplate position, then use screws (49) to secure the whole assembly.)

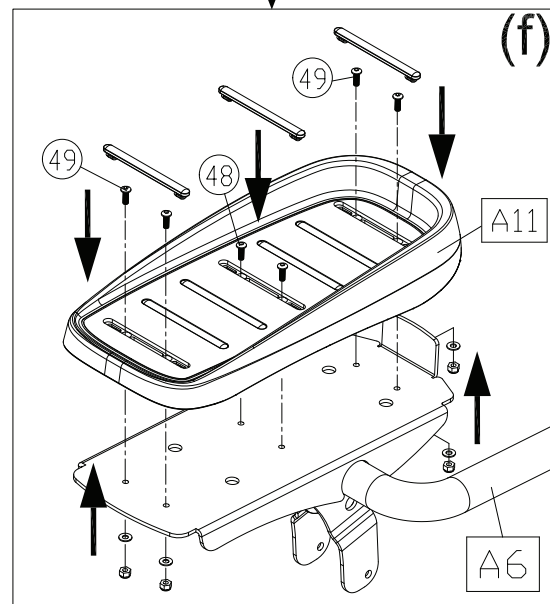

(g) Lubricate the area where the rod contacts the bushing, hold the footplate carriage into place, and secure it with screw (47). Perform the same actions on both sides of the product.

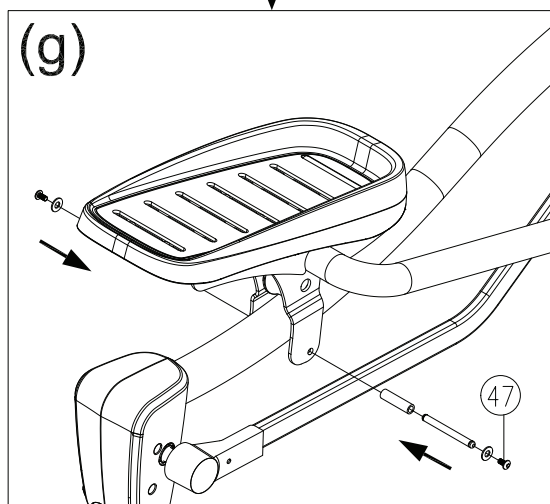

STEP 5 Install Left/Right Supports

Please follow instructions (a) through (f) to install left and right supports.

(a) Remove screws and remove covers from the top of the left and right supports.

(b) Remove screws (43)(44) from both sides.

(c) Put left and right supports (A4,A5) into place and loosely secure screws (43) at the top. Do not fully secure these screws yet.

(d) First, secure screws (44) at the base of the supports (A4,A5). Then go back to the top and secure screws (43).

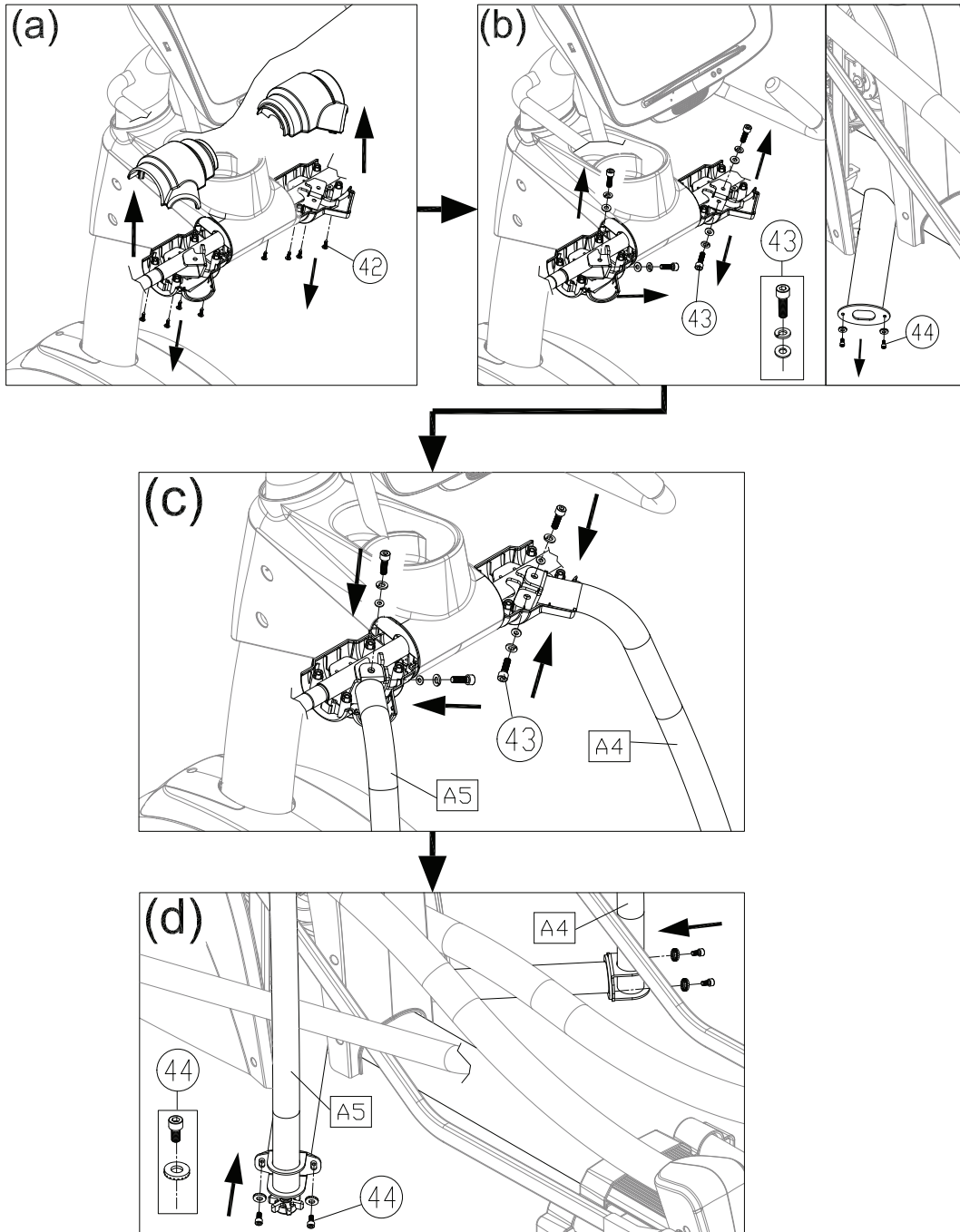

STEP 5 Install Left/Right Supports (Continued)

(e) Put support base covers (A8,A9) into place on both supports (A4,A5), and secure them with screws (34).

(f) Set upper covers into place on both supports, and secure them with screws (42).

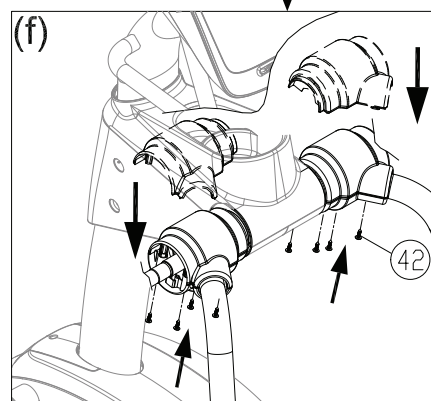
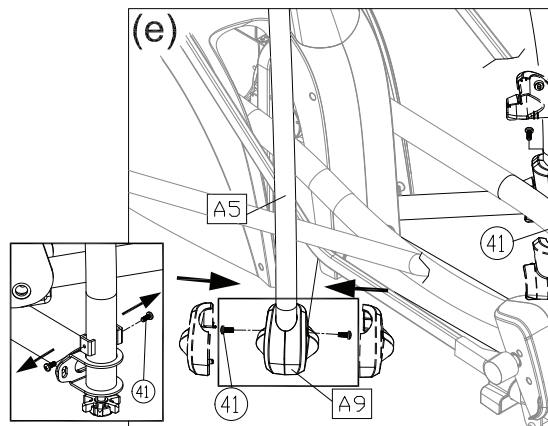

STEP 6 Secure the Rail Base Cover

Please follow instructions (a) through (b) to install the rail base cover.

(a) First, insert screw inserts (36) into the rail base plate.

(b) Set the rail base cover (A1A) in place and secure it with screws (33).

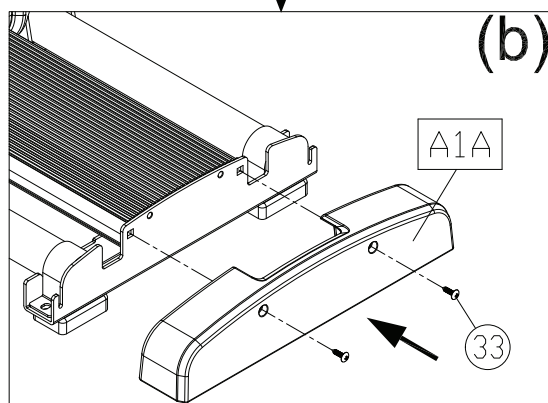
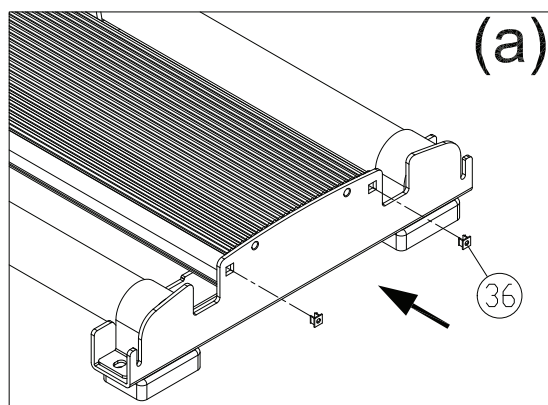

STEP 7 Move the Unit into Place

Follow steps (a) through (c) to move the unit into place for use.

(a) Stand behind the unit. Grasp the glide track rods as shown.

(b) Lift up. (To avoid injury, always use proper lifting techniques.)

(c) Push while using the transport wheels to roll the unit into place.

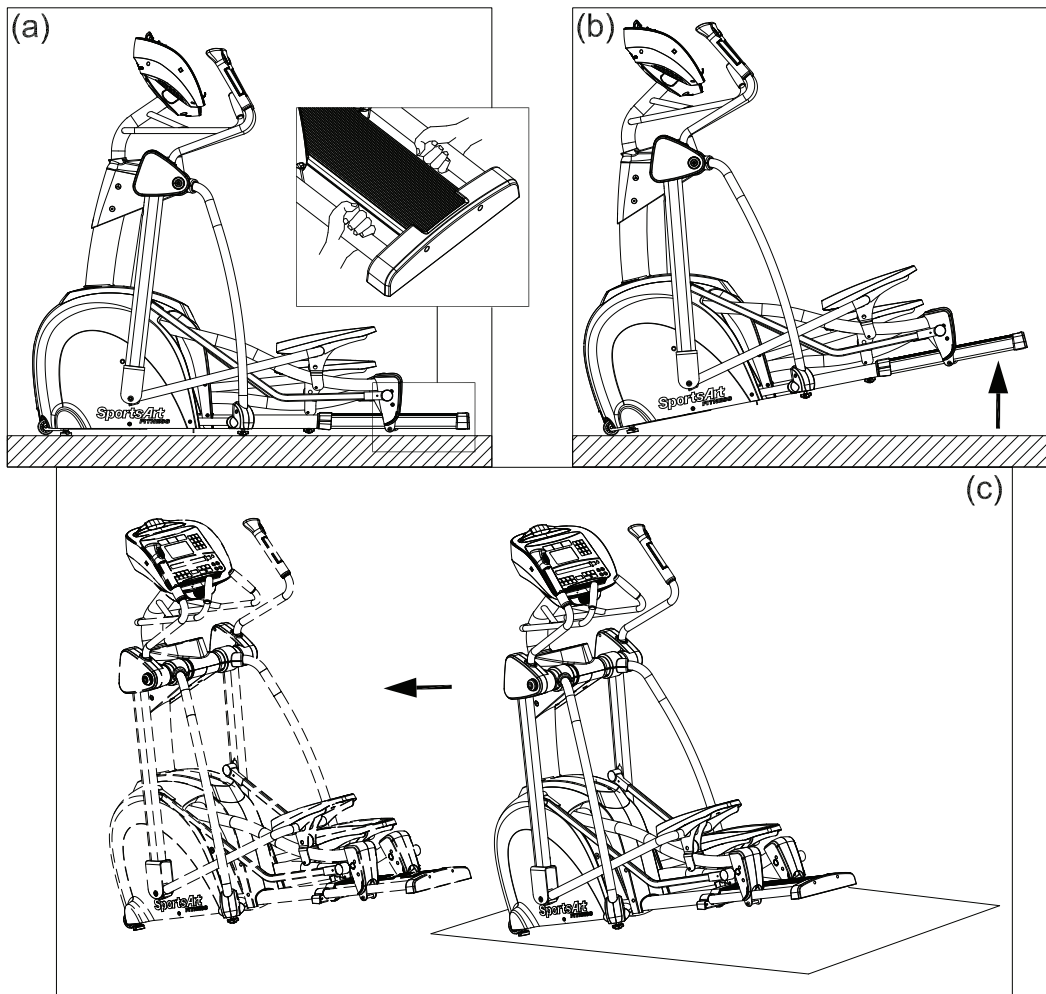

STEP 8 Level the Unit

If the unit does not rest flat on the floor, please follow steps (a) through (b) to level it.

(a) Under the front of the unit, rotate the leveler nut upward to enable adjustment of the leveler foot. Then screw the leveler foot downward until it touches the floor. Rotate the leveler nut against the product frame to secure this position. Carry out these instructions on both sides of the product.

(b) Under the support, rotate the leveler nut upward to enable adjustment of the leveler foot. Then screw the leveler foot downward until it touches the floor. Rotate the leveler nut against the product frame to secure this position.

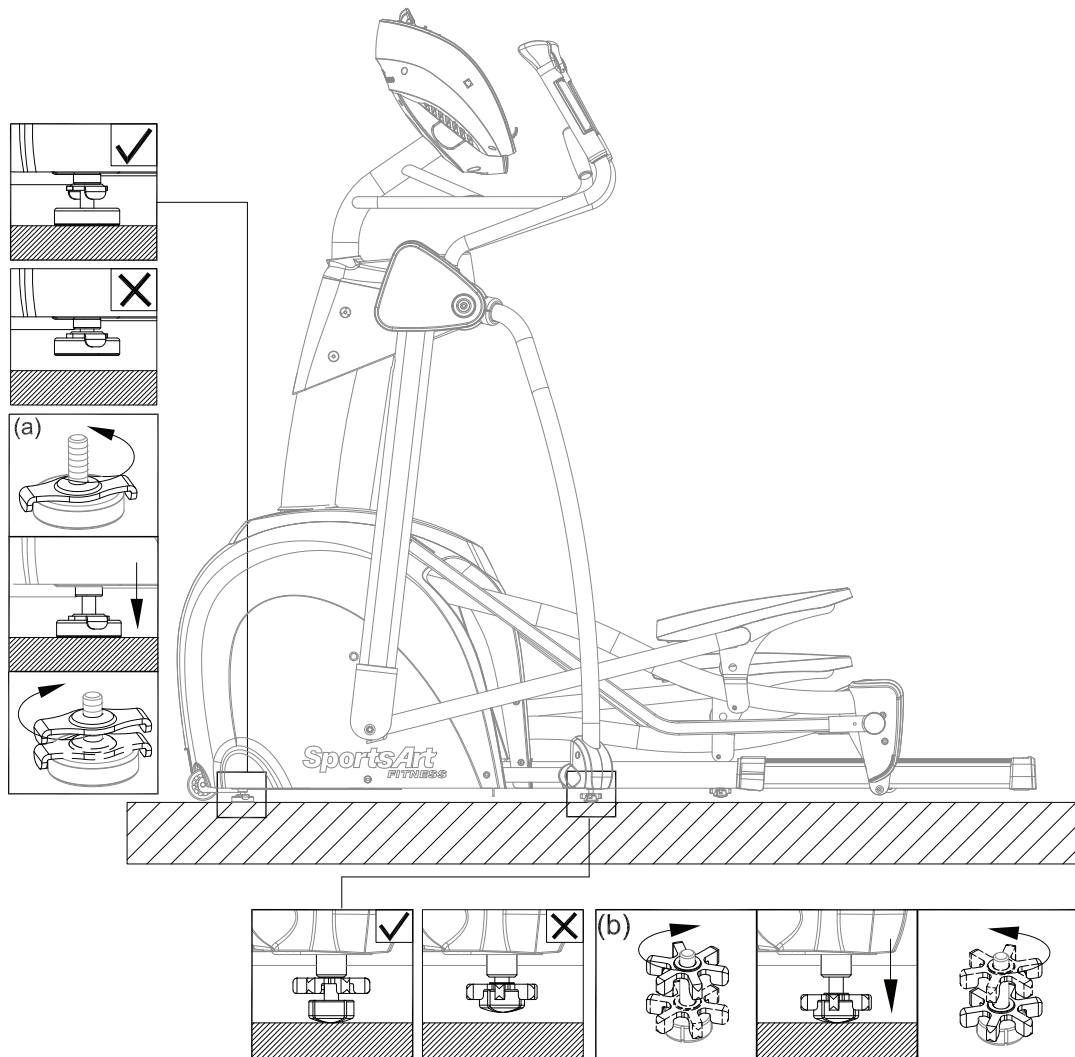

STEP 9 Ground Wire Installation

The ground wire and the following instructions are required to meet European safety regulations. The ground wire is not required in North America.

Overview: To prevent electrical shock and current leakage, a ground wire is provided in the packaging of this product. For your safety, connect this ground wire to the unit and the building ground. Installation procedure: First use a screw to secure the ground wire to the front of the product as shown. Secure the other end of the wire to the main facility ground connection.

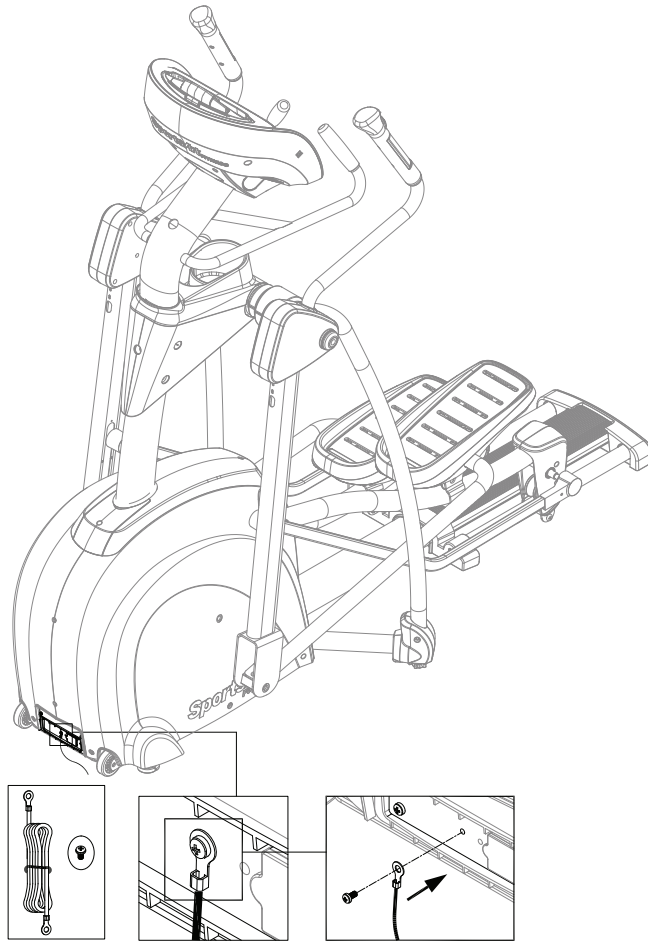

STEP 10 Beware of Moving Parts

While the product is in use, be careful to avoid getting pinched by or wedged against moving parts. In particular, do not insert fingers or other body parts into the stride adjustment area or the opening in the front covers. Prevent injuries to yourself and others by employing safe operating practices at all times.

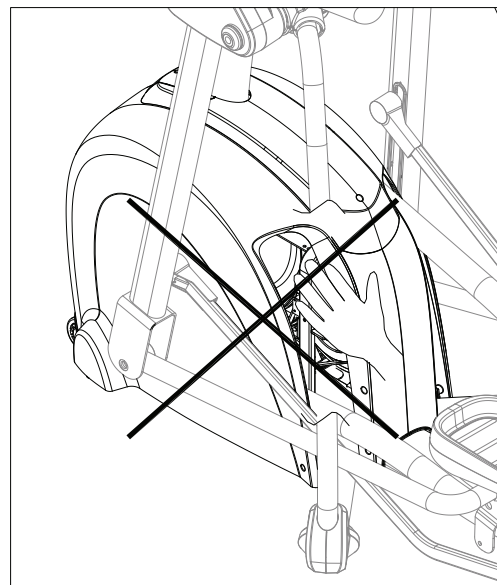
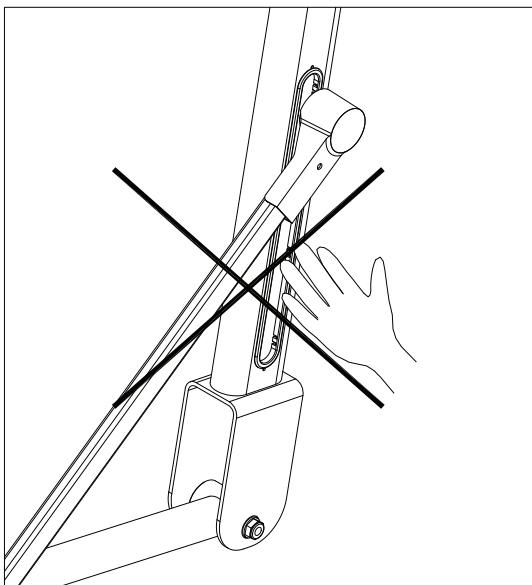

5. UNDERSTAND THE E865 DISPLAY

DISPLAY Overview

The E865 elliptical trainer is designed for user convenience. With better feedback about your workout, you get better results. The following explains the display key and window functions. Please read this manual, understand the display functions, and thereby get optimum enjoyment and benefit from this product.

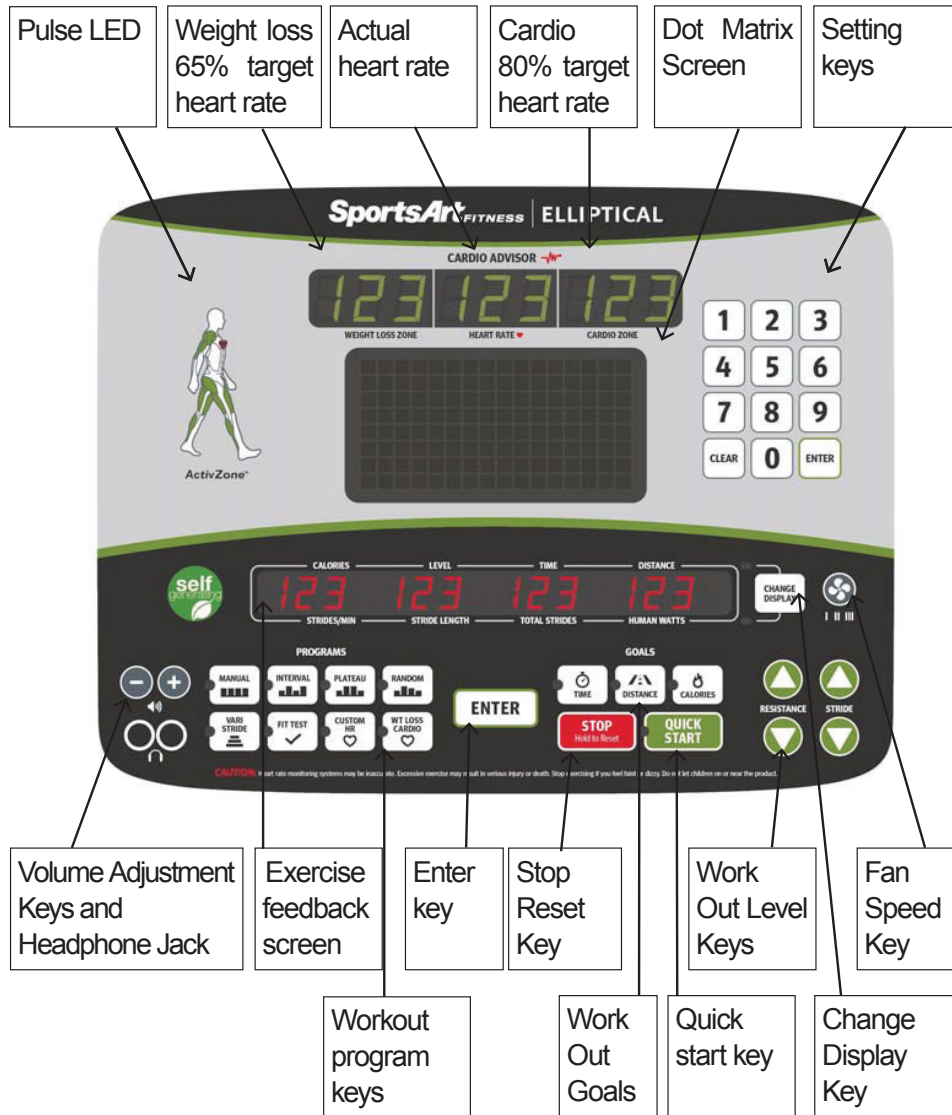

DISPLAY Specifications

Workout level (resistance level): 1 - 40

- Time: 0:00 - 300:00
- Distance: 0.00 - 9999 km or mile
- Calories: 0.0 - 9999 kcal
- Heart Rate range: 40 -250bpm
- Stride per minute (SPM): 5 – 120 (Range shown)
- Human Watts: 0 – 9999
- Total strides (accumulated stride count): 0 - 9999
- Stride length: 17 - 29 inch (450 - 730mm)
- Programs: MANUAL, INTERVAL, PLATEAU, RANDOM, VARI-STRIDE, FIT TEST, CUSTOM HR and CARDIO/WT LOSS.

DISPLAY Windows

- Cardio Advisor™ shows heart rate goals, WT LOSS 65% and CARDIO 80%, and actual heart rate (center).
- The exercise feedback window shows workout usage prompts and workout information.
- The workout illustration window shows workout program illustrations.

DISPLAY Keys

Display key functions are introduced briefly below.

QUICK START – Press this key to start exercising without first entering age, weight, and other user information. During pause mode, press this key to resume the workout. During program set up, press this key to start using the selected program.

MANUAL – This key allows you to directly control resistance, via resistance keys.

INTERVAL – Press this key to select one of three interval programs: 1:1, 1:2, 2:2. Numbers represent minutes. For example, the 1:1 interval program consists of one minute of rest, followed by one minute of work.

PLATEAU – This workout program gradually increases in difficulty, plateaus, then tapers off, in a 20-60-20 pattern.

RANDOM – Press this key to select one of an almost endless number of randomly generated workout programs. Each key press, the console will randomly generate a different program.

DISPLAY Keys (Continued)

VARI-STRIDE – This workout program automatically changes stride. Exercisers can select maximum stride.

FIT TEST – Press this key to enter a FIT TEST program and start the fitness test.

CUSTOM HR – This heart rate control program allows you to set your own target heart rate.

WT LOSS – A heart rate control program, the weight loss workout is designed to keep the exerciser's pulse at the optimum rate for losing weight. Resistance settings change automatically to maintain a target heart rate calculated by the formula $(220-AGE)*0.65$.

CARDIO – A heart rate control program, the cardio conditioning workout is designed to keep the exerciser's pulse at the optimum rate for cardio conditioning. Resistance settings change automatically to maintain a target heart rate calculated by the formula $(220-AGE)*0.8$.

TIME – Press this key to make time your workout goal.

DISTANCE – Press this key to make distance your workout goal.

CALORIES – Press this key to make calories your workout goal.

ENTER – After making a selection, press this key to confirm your choice.

RESISTANCE ▲/▼ – Press this key to change resistance settings. Settings change by one level each time the key is pressed.

STRIDE LENGTH ▲/▼ – Press this key to change stride settings. Settings change by one value each time the key is pressed.

STOP/HOLD TO RESET – During a workout, or Cool Down mode, press this key to display the workout information such as time, distance and calories. At workout summary display mode, press this key to end this program and return to idle and the display will show: SELECT A PROGRAM. At anytime of a program, press and hold this key for 2 seconds, it will reset the console and return to idle mode.

0 – 9 numeric keys – Press these keys to directly input numbers, rather than pressing ▲/▼ keys.

CLEAR – When inputting setting values, press this key to delete previous setting values back to 0.

FAN – Press this key to activate the fan. There are settings: low, medium, high, and off.

DISPLAY Keys (Continued)

CHANGE DISPLAY – This key controls the exercise feedback window, which has two rows: The top row shows CALORIES, LEVEL, TIME, DISTANCE; the bottom row shows STRIDES/MIN, STRIDE LENGTH, TOTAL STRIDES, HUMAN WATTS. Corresponding LEDs light to indicate the active row of exercise feedback. Press the CHANGE DISPLAY key to toggle between top and bottom feedback row views.

VOLUME + / - : iPod, iPhone analog audio volume adjustment. (Note: this is an option feature and it is only compatible with Apple 30 pin connector.)

6. OPERATE THE PRODUCT

There are two ways to start operating this product, either through the QUICK START mode or through a workout program.

OPERATION Quick Start

Press the QUICK START key to start exercising immediately, without inputting any user information. TIME goal LED indicator will light up. The program time is default at 60 minutes unless the program time limit is activated in the engineering mode. In QUICK START mode, resistance begins at level 1; calorie and other information is based on a 35 year old and 165 lb. (75 kg) user. Both QUICK START and MANUAL LEDs are lit up to indicate QUICK START program is in session. In QUICK START mode, resistance and stride settings can be modified at any time.

OPERATION Start a Workout Program

To obtain more accurate calorie counts and target heart rates, operate the product via a workout program as follows:

1. Press a workout program key (MANUAL, INTERVAL, PLATEAU, RANDOM, VARI-STRIDE, FIT TEST, CUSTOM HR, CARDIO/WEIGHT LOSS) to select a workout or press a goal key (TIME, DISTANCE, CALORIES) to select a goal program. Press ENTER to confirm the program selection.

2. If you select a program key, then “SELECT GOAL” will appear on the exercise feedback window. There are three types of workout goals: TIME, DISTANCE, and CALORIE. Press the key of your preferred workout goal. Its indicator LED will light up.

If you select a goal program, its LED indicator will light up. Follow the instruction below to set up the goal and start the program. Once the program is started, resistance and stride setting can be modified at any time.

- The TIME setting range is from 5:00 to 300:00, with a default value of 30:00. If the program time limit is activated in engineering mode, the max time can be entered will change accordingly.. Use ▲/▼ keys or numeric keys (0-9) to make your selection. Press the ENTER key to confirm your

OPERATION Start a Workout Program (Continued)

setting and proceed to input your age. Or press QUICK START key to start this program right away with default age and weight.

- The DISTANCE setting range is from 0.1 to 99.9 miles or kilometers, with a default value 2.0 miles (3.0 kilometers). If the program time limit is activated at the engineering mode, then the DISTANCE goal will be deactivated. Use ▲/▼ keys or numeric keys (0-9) to adjust the setting. Press the ENTER key to confirm your setting and proceed to input your age. Or press QUICK START key to start this program right away with default age and weight.

- The CALORIE setting range is from 100 to 9999 kCal, with a default value of 700 kCal. Use ▲/▼ keys or numeric keys (0-9) to make your selection. Press the ENTER key to confirm your setting and proceed to the age setting. Or press QUICK START key to start this program right away with default age and weight.

3. The age setting range is from 10 to 90, with a default value of 35 years old. Use ▲/▼ keys or numeric keys (0-9) to make your selection. Press the ENTER key to confirm your setting and proceed to the weight setting. Or press QUICK START key to start this program right away with default weight.

4. The weight setting range is from 50 to 500 lb. (20 to 227 kg), with a default setting of 165 lb. (75 kg). Use ▲/▼ keys or numeric keys (0-9) to make your selection. Press the ENTER or QUICK START key to confirm your setting and start exercising.

Follow prompts to begin your workout. Please refer to OPERATION Workout Programs for information about specific workout programs.

Note that a different workout program can be activated simply by pressing the other workout program key. The workout goal will remain the same, and progress toward the workout goal will continue to accrue.

OPERATION Display

1. If the feedback window is at top row, press STRIDE ▲/▼ key to adjust the stride length, the display will temporary switch to lower row to show the adjustment. In 4 seconds, it will return to top row. Same thing will happen if it is displaying bottom row, and RESISTANCE ▲/▼ key is pressed, it will temporary switch to top row.

2. Heart Rate display: it will display the actual heart rate bpm.

3. During workout, user can switch to a different workout program using the same goal by pressing a different program key. There are some exceptions, listed below:

- During MANUAL, INTERVAL, PLATEAU, RANDOM, VARI-STRIDE, CUSTOM HR, WT LOSS & CARDIO workout, it can't be switched to FIT

OPERATION Display (Continued)

TEST program.

- Switch program is not allowed during FIT TEST program.

OPERATION Cool Down

Once the workout goal (time, distance, or calorie expenditure) has been obtained, the product will enter a two-minute cool down period. The display will count down from two to zero.

When the countdown reaches zero, the cool down period will end. The message "REVIEW SUMMARY" will appear, along with accumulated workout information, including total time, distance and calorie expenditure. Press the STOP key to return to idle mode which the "SELECT A PROGRAM" prompt will appear.

OPERATION Workout Programs

The following explains features of the workout programs.

MANUAL

This program allows you to manually control resistance. In manual mode, simply press RESISTANCE ▲/▼ keys to control resistance, or STRIDE ▲/▼ keys to control stride length.

INTERVAL

There are three interval programs: INTERVAL1:1, INTERVAL1:2, INTERVAL 2:2. Each interval program includes two segments, a work segment and a rest segment. (Example: Interval 1:1 indicates one segment of one minute in duration, followed by a second segment of one minute in duration.)

Each time the INTERVAL key is pressed, one of the three interval programs will appear. When your preferred interval program appears, press the ENTER key to activate that program. Then follow prompts to set the interval segment resistance settings. After you begin exercising, the resistance level of any segment can be changed. Simply press RESISTANCE▲/▼ keys during the segment to do so. The new resistance level will then become the resistance level each time that segment is activated.

PLATEAU

Resistance levels in this workout gradually increase, level off, then gradually decrease. The first and last segments of this workout each occupy 20% of the workout. The middle segment occupies 60% of the workout. Follow prompts to establish your workout goal.

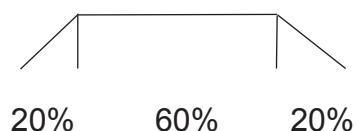

OPERATION Workout Programs (Continued)

RANDOM

This program provides a near infinite number of randomly generated workouts. A new workout illustration appears each time the RANDOM key is pressed.

VARI-STRIDE

In this program, stride length changes automatically during a 20-minute, 30-minute, or 40-minute workout session. There are three programs: VARI-STRIDE 20; VARI-STRIDE 30; VARI-STRIDE 40.

Each time the VARI-STRIDE key is pressed, one of the three programs will appear. Press ENTER to select the desired program.

After selection, press ▲/▼ keys to set your maximum stride length when display shows "MAX STRIDE - XXX". Range is 25 - 29 inch (630 - 730mm), with a default setting of 25 inch (630mm). Then press the ENTER key to confirm your choice.

During program setting, you may press QUICK START to start the program right away. The maximum stride length can be adjusted during exercising by pressing STRIDE ▲/▼ keys.

FIT TEST

The FIT TEST program is designed for physical fitness assessments. The program is set with a time limit; therefore it is not restricted by the program time limit setting at the engineering mode.

After you press the FIT TEST key, the display will show "STARTING TEST" to begin this program. The test is divided into 4 segments of 3 minutes; it will compare the actual Watts and the preset Watts in each segment and adjust the resistance accordingly.

During the test, the Red dot in the dot matrix window represents the target SPM and the orange dot represents the actual SPM. You want to match the actual SPM to the targeted value. The best SPM range during test is between 40SPM to 70SPM with targeted 50SPM. If the actual SPM is below 40SPM for more than 5 seconds, the display will ask you to "SPEED UP" and if it is above 70SPM for more than 5 seconds, it will ask you to "SPEED DOWN".

Following conditions occurs will end this test program:

1. STOP key is pressed.
2. Program time ends.
3. Actual Heart Rate is $> (220 - \text{Age}) \times 0.8$ for more than 15 seconds.
4. No heart rate detected for more than 30 seconds.
5. The speed is slower than 60SPM or faster than 90SPM for more than 5 seconds.

OPERATION Workout Programs (Continued)

The message will display “END OF FIT TEST” and “YOUR SCORE - XXX”. (The max score is 100 and min is 0)

CARDIO/WEIGHT LOSS/CUSTOM HR

In these heart rate control programs, the resistance level will automatically change to keep the exerciser's pulse at the optimum rate for achieving his or her fitness goals. Target heart rates are calculated based on a standard “maximum” heart rate for the exerciser's age. The weight loss target heart rate is calculated at 65% of the maximum heart rate: $(220 - \text{age}) * 65\%$. The cardio target heart rate is calculated at 80% of the maximum heart rate: $(220 - \text{age}) * 80\%$. Custom target heart rate is set by user.

If CUSTOM HR is selected, the target heart rate will need to be set first. The range is 84 - 199bpm with default value of 120bpm. The display will show “TARGET HR - XXX” for setting. Press ▲/▼ key or numeric keypads 0-9 to adjust the setting. Press ENTER key to confirm and start the program. You may press QUICK START at anytime to begin the program right away using default values.

After a heart rate control workout is activated, a heart illustration will appear on the dot matrix screen. When the actual heart rate signal is detected, the color of the heart illustration will alternate between red and green. Otherwise, it will maintain with green color. Orange color represents the 65% or 80% of max HR or target heart rate entered.

Once the exerciser begins to exercise, a red dot and a orange line will appear on the lower part of the screen. The red dot represents the recommended RPM; the orange line represents actual RPM. Try to maintain an RPM even with the red dot.

Resistance will start at level 1. The default RPM is 50. If the actual RPM is 5 revolutions below the recommended step rate for 25 seconds, “SPEED UP” will appear on the exercise feedback window.

A telemetry heart rate transmitter must be worn during heart rate control programs. If no heart rate signal is received at the display, the message “NO HEART RATE READING, PLEASE CHECK TRANSMITTER” will appear, and resistance will not change automatically.

OPERATION User Preferences and Component Versions

Basic settings determine units of measure and show total distance and time, along with display and drive board program version numbers. To access this information, at the startup banner screen, hold the CHANGE DISPLAY key for two seconds.

UNITS

The display will show “UNIT – MILE” or “UNIT – KM” depending on the original distance unit setting. Press ▲/▼ keys to toggle between the two settings. When your preference appears, press the ENTER key to make your selection.

PROGRAM TIME LIMIT

The display will show “TIME LIMIT - YES” or “TIME LIMIT - NO”, press ▲/▼ key to turn this function On/Off. Press ENTER to make your selection. When “YES” is selected, it will prompt the message of “TIME - XX:00” for you to set the time limit. Setting range is from 5:00 to 60:00, with a default value of 30:00. Press ▲/▼ key or numeric keypads (0-9) to adjust the value. Press ENTER to confirm the setting.

LANGUAGE

The display will show the current country code selected twice, such as “US”. After that, it will display “XX MILE H>H” or “XX KM H>H” (XX represents the country code). Press ▲/▼ key to change the country code. Press ENTER to confirm the selection.

TOTAL DISTANCE

According to the speed unit setting, total distance will appear as either “DIST – XXXXXX MILE” or “DIST – XXXXXX KM”, where XXXXXX represents a number. Press the ENTER key to view total time.

TOTAL TIME

Total time of use will appear as “TIME – XXXXXX HOUR”, where XXXXXX represents a number. Press the ENTER key to view display program version..

DISPLAY PROGRAM VERSION

The display program version will appear as “CTL E8_5– XX”, where XX represents either letters or numbers. Press the ENTER key to view the drive board program version.

DRIVE BOARD PROGRAM VERSION

The drive board program version will appear as “DRV E875_SG-XX”, where XX represents either a letter or a number. Press the ENTER key to finish the review and return to Banner mode.

You may press and hold STOP key at anytime during this process to resent the console and back to Banner state.

7. ABOUT HEART RATE DETECTION

Heart rate detection functions are selected at the time of purchase. Not every product has every type of heart rate detection. The following explains factors that influence the performance of two of the most common types of heart rate detection devices.

HEART RATE Telemetry

The words “telemetry heart rate” refer to the detection of heart rate via a device worn on the exerciser and transmitted over the air to a circuit board built into the product. Telemetry heart rate devices are commonly worn on the exerciser’s chest, where the pulse is strongest and relatively easy to detect.

The following explains conditions that affect the performance of the telemetry heart rate function in all fitness products.

- The telemetry heart rate transmitter emits a wireless 5 kHz signal that is harmless to the human body. Inside the transmitter is a 3 V battery (CR2032). If the battery voltage is too low, either the reception distance shortens or there will be no reception whatsoever.
- Secure the telemetry heart rate transmitter on your chest so that it stays in place without making you feel uncomfortable. Moisten the skin for better contact.
- Because the telemetry heart rate signal varies in strength from 20 Hz to 20 KHz, environmental interference can block signal reception. Physical vibration and electronic devices, including stereos, TVs, and even fluorescent lights, can interfere with signal reception. For best results, install fitness products in an area free from such interference.
- Space fitness products apart by at least 39 inches (100 cm) to avoid having the heart rate value from one exerciser appear on a neighboring fitness product.

HEART RATE Contact

The words “contact heart rate” refer to the detection of the heart rate via sensors on the fitness product. By holding the sensors, the exerciser can view his or her heart rate on the product display. Like telemetry heart rate, contact heart rate can be influenced by several factors. The following list includes some of these factors.

- A weak pulse makes it difficult to detect heart rate.
- Low systolic blood pressure makes it difficult to detect heart rate.
- Dry, course palms impede heart rate detection. For best results, moisten your palms. But do not apply hand lotion immediately prior to your workout, because hand lotion can gum up the contact pads.

Heart rate devices built into this fitness product are not medical devices. Heart rate values are for reference only. Do not use them for medical diagnostic or treatment work.

CAUTION: Heart rate detection and transmission devices have been known to interfere with the operation of pacemakers, possibly endangering human life. If you have a pacemaker, exercise under your doctor's supervision; take a test to ensure your safety during the simultaneous use of the pacemaker and heart rate detection devices. The use of such devices must be undertaken at your own risk.

Note that in dry areas in particular, static electricity can interfere with unit operation and shock people. To discharge static electricity from your body, touch something else before touching metal on the fitness product.

8. GUIDELINES FOR EXERCISE

HOW HARD SHOULD I EXERCISE?

Studies show that to benefit from aerobic exercise, people need to maintain a certain heart rate during their workouts. Your heart rate training zone depends on your age and fitness level.

The darkened area in the chart to the right represents the recommended heart rate training zone for people of various ages. It was calculated by taking 220 minus age in years, multiplied by 65% and 80%. The area between those values is the heart rate training zone.

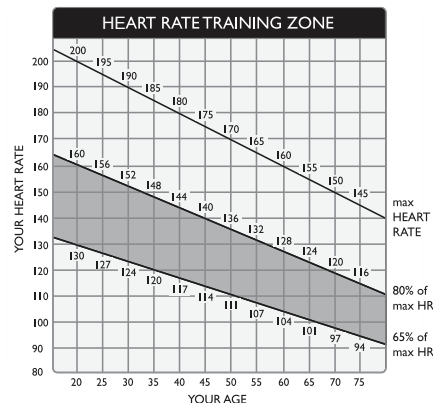

CAUTION: Heart rate training zones are generalizations and may not suit every person. Always check with your physician to understand what heart rate goal would be appropriate for you.

HOW LONG SHOULD I EXERCISE?

The duration of your workout must depend on your fitness level. In general, it is recommended that you maintain a heart rate within your training zone for at least 15 to 20 minutes to experience the benefits of aerobic exercise. Beginners should always start out slowly and gradually increase the duration and intensity of their workouts. As your fitness level improves, you will be able to maintain a heart rate within the training zone for longer periods of time.

When you begin your workout, use the first several minutes to warm up. Then slowly increase the intensity of your workout to bring your heart rate into your training zone. At the end of your workout, gradually decrease your workload. Then exercise lightly to cool down.

HOW OFTEN SHOULD I EXERCISE?

Research indicates that to achieve the greatest benefit, people should exercise three to five times per week. It is important to allow sufficient time, at least 24 hours, for your body to recover after exercise.

9. ACCESSORIES

There are accessories attached to this console; some are standard and some are optional. The following explains the details of each accessory and its function.

USB CHARGER (Standard)

The USB charger will provide 5V 500mA voltage for the smart phone or other devices charging. However it is not compatible with Apple products, such as iPod, iPhone nor iPad. Check the device for charging details.

CSAFE PORT (Standard)

Compatible with CSAFE (Communications Specification for Fitness Equipment) Protocol. It works with optional Netpulse Personal Entertainment System as well as ECOFIT System.

iPod/iPhone/iPad 30 pin connector (Option)

When connecting the device to the 30pin connector, user can listen to music via headphone jack and adjust the audio volume thru the on board volume control keys.

SAFitDirector Member System (Option)

This is a system designed specially by SportsArt to assist user managing his/her workout history. There are three ways to get connected with the member site:

1. Use Bluetooth in the smart phone and SAFitDirector App.
2. Use USB Flash Drive to store the workout data.
3. Use member card to access user profile and workout tracking.

9. ACCESSORIES (CONTINUED)

Entertainment Cap

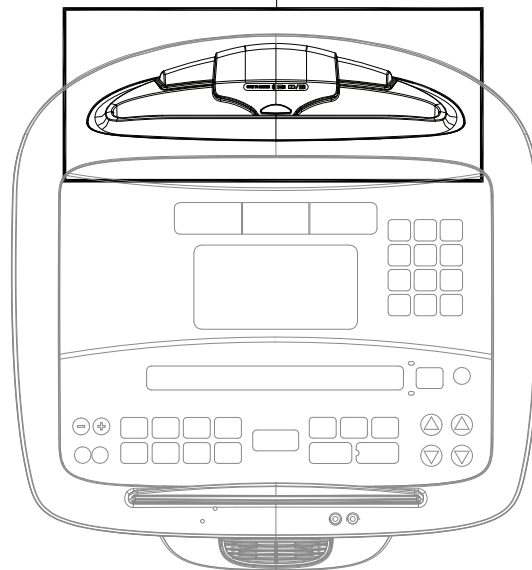
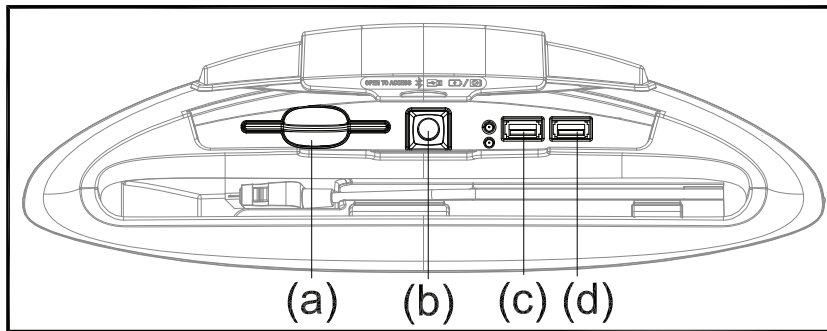

The functions of the Entertainment Cap of the display:

- (a) RFID member card slot: work with both optional SAFitDirector and ECOFIT member cards.
- (b) Bluetooth connection button: press this button to pair or unpair the smart phone SAFitDirector App.
- (c) USB port: this port is used for device charging as well as optional data transferring.
- (d) USB port: this port is used for device charging.

10. MAINTENANCE

Maintenance topics are presented below in the following order: error messages, lubrication of the shoulder area, lubrication of the stride area, glide rail cleaning, maintenance schedule, task list, one-year maintenance log, and electronics block diagram.

MAINTENANCE Messages

The following messages can appear on this product for diagnostic purposes.

NO STRIDE ADJUST UNDER 30SPM - Indication: stride length can not be adjusted due to speed is under 30SPM. It appears when STRIDE ▲/▼ key is pressed to adjust the stride but the actual speed is under 30SPM.

SERVICE BATTERY - Indication: the battery is low. It appears when the STRIDE ▲/▼ key is pressed to adjust the stride length but the actual speed is under 30SPM and battery is low. To solve this issue, you can continue pedaling to recharge the battery or plug in the optional battery charger to charge the battery.

ERROR 7 L, ERROR 7 R & ERROR 7 R/L - Indication: There is a communication error between control board and driver. Contact a certified SportsArt technician. The technician will need to either inspect the stride motor or the driver.

ERROR_8_1, ERROR_8_2 - Indication: There is a communication error between control board and driver. Contact a certified SportsArt technician. The technician will need to either inspect the stride motor or the driver.

---- (Four flashing lines) - Indication: The unit is entering the energy saving mode. The main display will shut off, and keys will remain lit. To reactivate the unit, press a key or exercise on it.

MAINTENANCE Lubrication

To enter Lubrication function, first you must set the console to the Lubrication state. During Banner mode, the message shows "SELECT A PROGRAM", press STRIDE ▲ and STRIDE ▼ and STOP keys at the same time for 3 seconds to activate this procedure. Once Lubrication procedure is activated, the stride motor will move to the correct position and the message will display "LUBRICATION". At this time, it is ready for lubrication. Please follow the lubrication procedure listed on the following page to start lubricating.

Once the lubrication procedure is completed, please follow below instruction to return the stride length to 29"/730mm.

1. When the power is off, pedaling the elliptical to turn on the power.
- Or 2. Press and hold the STOP key for 2 seconds to reset.

The lubrication process is now completed.

MAINTENANCE Lubrication Procedure

Please follow instructions (a) through (h) to lubricate the product.

- (a) Remove the cap that covers the lubrication hole.
- (b) Use an automobile grease gun to apply red lithium bearing grease into the nozzle on the product.
- (c) After applying lubricant, detach and remove the grease gun.
- (d) Insert the cap back into place.

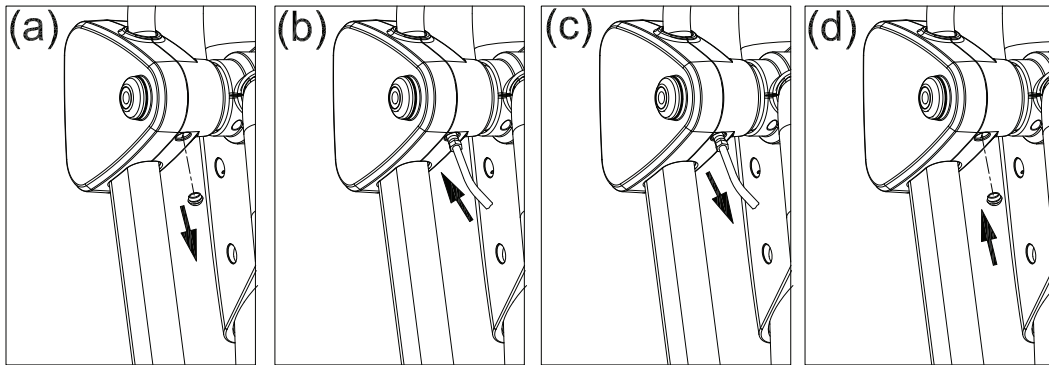

- e) Push in at point A, and slide upward to remove the lubrication hole cover.
- f) Press the stride up key to adjust the stride to its longest point. Note the grease fitting at area B.
- (g) Use an automobile grease gun with red lithium grease. Apply the grease to the nozzle on the product.
- (h) Put the cover back into place, pushing inward at step 3 and downward at step 4, as shown below. Note that point A provides the best contact surface on the lubrication hole cover.

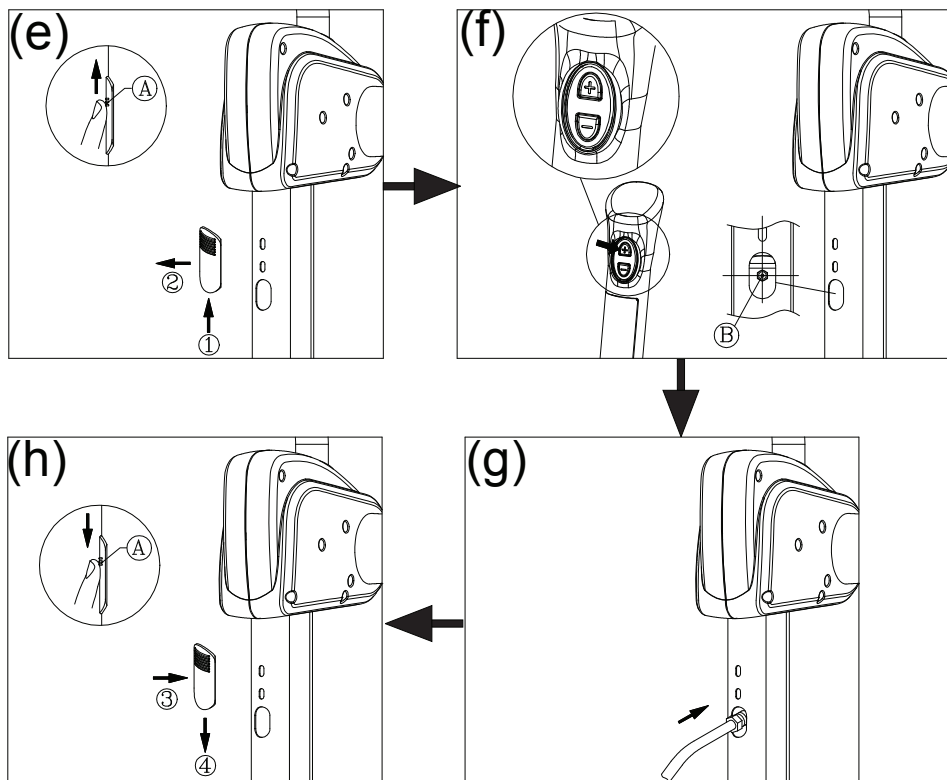

MAINTENANCE Cleaning the Glide Rail

Clean the glide rails once a day as follows:

- (a) Use a clean, lint-free cloth to wipe dust and debris off the glide rails.
- (b) Operate the product to inspect it and to determine where dirt might remain on the glide rails.
- (c) Repeat steps (a) and (b) two or three times to make sure glide rails are clean.

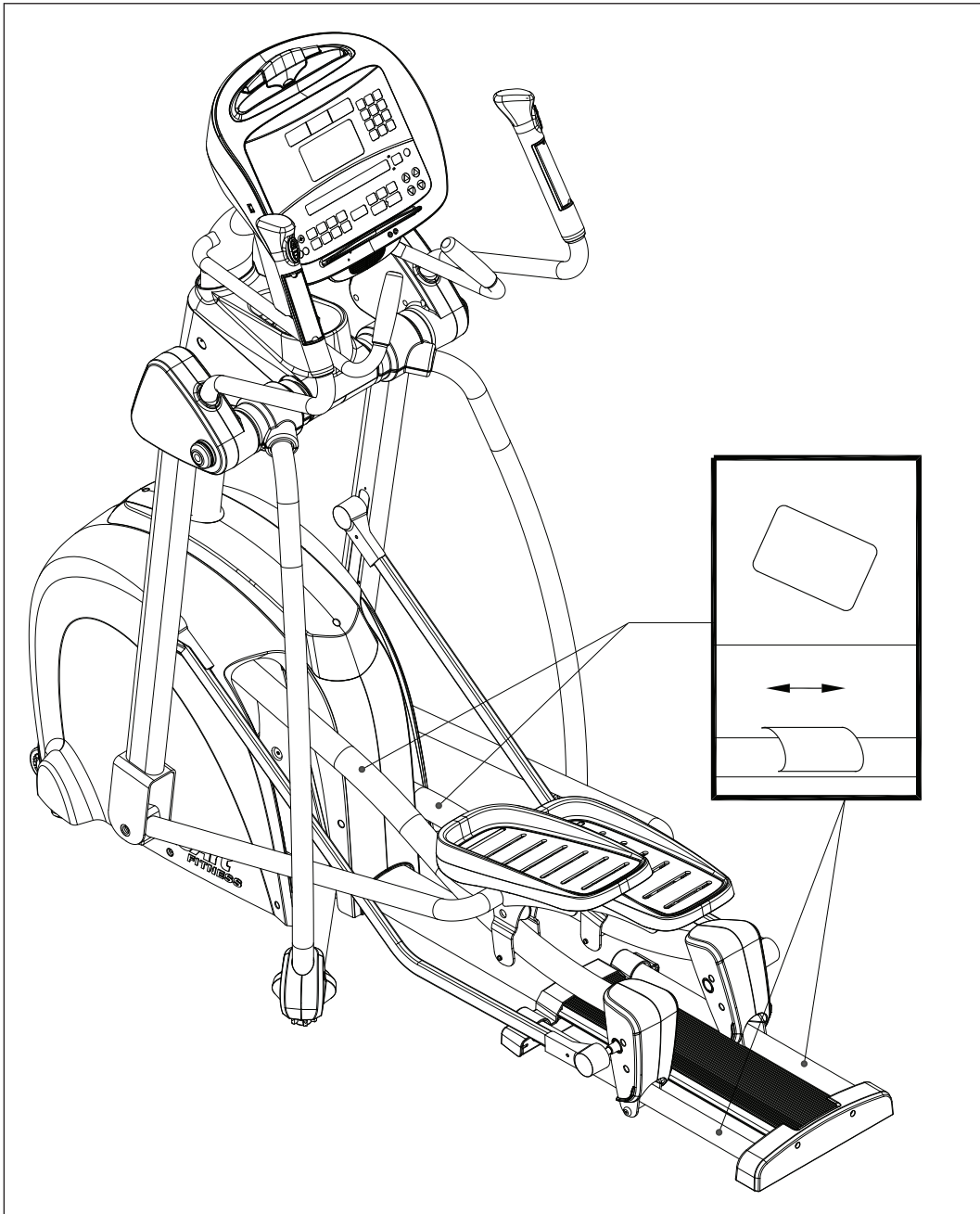

MAINTENANCE Schedule

	Area	Day	Week	Month	Quarter	Year	Notes
1	Exterior	•					Clean
2	Screws	•					Inspect and secure loose parts
3	Glide rail	•					Wipe away dirt and debris.
4	Rollers		•				Apply silicone lubricant.
5	Stride motor					•	Apply grease.

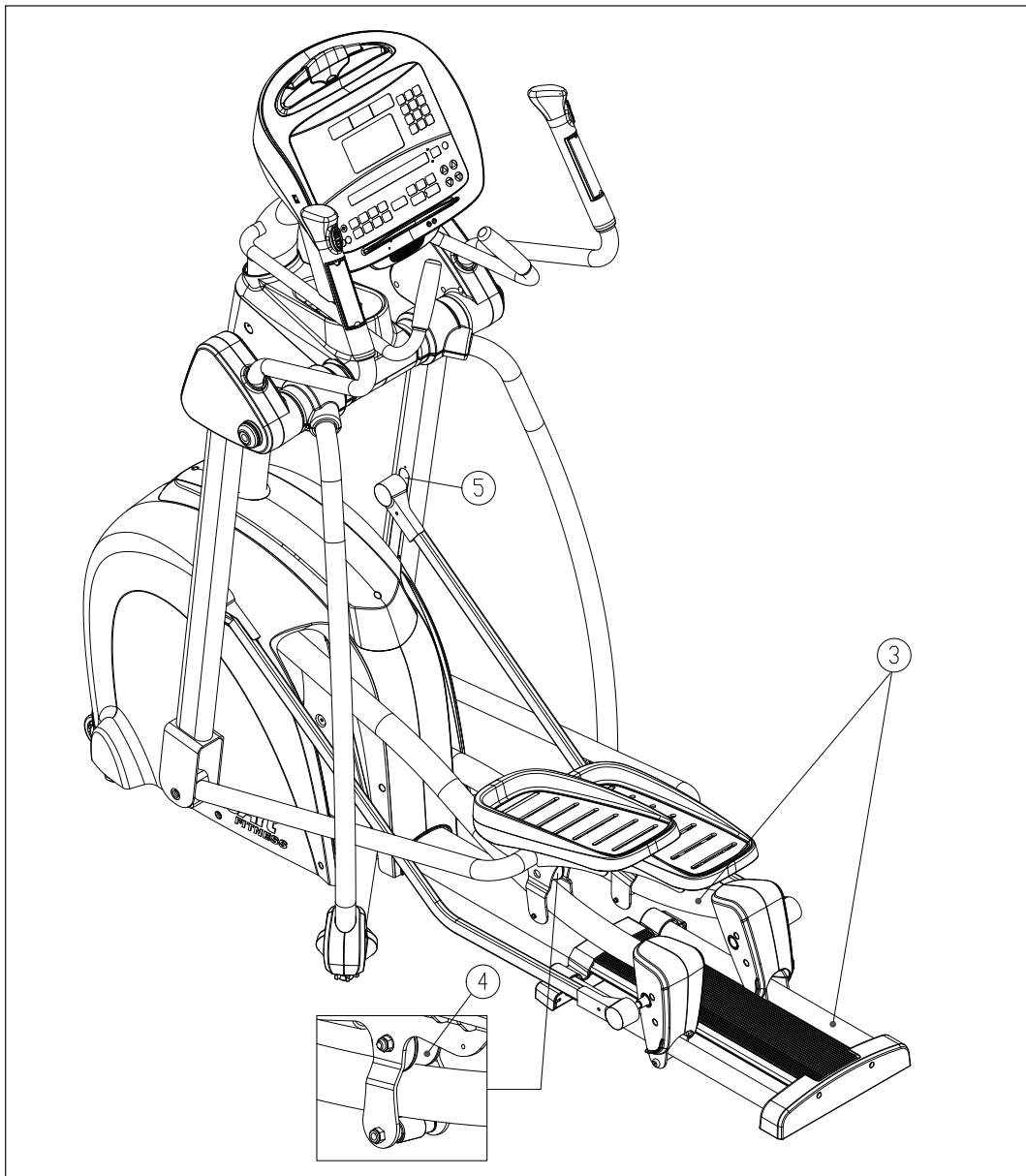

MAINTENANCE Task List (Elliptical Trainers)

Like cars, fitness products require maintenance. Regular maintenance extends product life, and failure to maintain products can void the manufacturer's warranty. Copy the maintenance log sheet, and record maintenance work for each fitness product.

Daily tasks

1. Use a clean, lint-free towel, dampened with a mixture of Simple Green® all-purpose cleaner and water, to thoroughly clean the product exterior.
2. Inspect parts for looseness, and secure all loose screws. Make sure that the product is safe for operation. If safety issues arise, place an "Out of Order" sign on the product, and call for service.
3. Wipe dirt and debris off the glide rails. Use a clean, lint-free towel, dampened with a mixture of Simple Green® all-purpose cleaner and water.

Weekly tasks

1. Clean rollers. Use a clean, lint-free towel, dampened with a mixture of Simple Green® all-purpose cleaner and water. Apply a small amount of silicone lubricant onto the rollers.

Yearly tasks

1. Apply grease to the stride mechanism.
2. Apply SportsArt 66A lubricant to the cushion.

Caution

- Please follow standard safety precautions when servicing on this product.
- Electronic components can carry an electrical charge even after the product has been turned off. For safety, turn off unit power. Wait five minutes to allow capacitors to discharge. Then disconnect the power cord from the wall socket (if applicable.) Only after such steps have been completed should covers be removed and electronic components accessed.
- Do NOT use cleaners with alcohol, ammonia, or other damaging chemicals. The use of such chemicals can damage the product and void the warranty. Never spray or pour any liquid directly onto the product. Doing so can damage electronic components and void the warranty.
- This product has moving parts that can be hazardous. Exercise caution when maintaining, operating, or moving this product.

MAINTENANCE One-Year Maintenance Log

Facility: _____ Supervisor: _____

Product model number: _____ Serial number: _____

Start date: _____ End date: _____

Daily Tasks	Weeks 1-7	Weeks 8-14	Weeks 15-21	Week 22-28
Completed	<input type="checkbox"/>	<input type="checkbox"/>	<input type="checkbox"/>	<input type="checkbox"/>

Daily Tasks	Week 29-35	Week 36-42	Week 43-49	Week 50-52
Completed	<input type="checkbox"/>	<input type="checkbox"/>	<input type="checkbox"/>	<input type="checkbox"/>

Weekly Tasks	Weeks 1-7	Weeks 8-14	Weeks 15-21	Weeks 22-28
Completed	<input type="checkbox"/>	<input type="checkbox"/>	<input type="checkbox"/>	<input type="checkbox"/>

Weekly Tasks	Weeks 29-35	Weeks 35-42	Weeks 43-49	Weeks 50-52
Completed	<input type="checkbox"/>	<input type="checkbox"/>	<input type="checkbox"/>	<input type="checkbox"/>

Monthly tasks	1	2	3	4	5	6	7	8	9	10	11	12
Completed	<input type="checkbox"/>	<input type="checkbox"/>	<input type="checkbox"/>	<input type="checkbox"/>	<input type="checkbox"/>	<input type="checkbox"/>	<input type="checkbox"/>	<input type="checkbox"/>	<input type="checkbox"/>	<input type="checkbox"/>	<input type="checkbox"/>	<input type="checkbox"/>

Quarterly Tasks	Quarter 1	Quarter 2	Quarter 3	Quarter 4
Completed	<input type="checkbox"/>	<input type="checkbox"/>	<input type="checkbox"/>	<input type="checkbox"/>

Yearly Tasks	Year 1
Completed	<input type="checkbox"/>

Notes: _____

MAINTENANCE Electronics Block Diagram

E865 (LED)

