

# G516 OWNER'S MANUAL CONTENTS

1. INTRODUCTION .....	3
2. SAFETY PRECAUTIONS .....	4
3. LIST OF PARTS .....	8
4. ASSEMBLE THE PRODUCT .....	10
STEP 1 Install the Stabilizers .....	10
STEP 2 Install the Padel's .....	11
STEP 3 Install the Handlebars .....	12
STEP 4 Install the Console .....	13
STEP 5 Moving the Bike .....	14
STEP 6 Leveling the Bike .....	15
STEP 7 Install the Power Cord.....	16
STEP 8 Handlebar/Seat Horizontal Position Adjustment .....	17
STEP 9 Handlebar/Seat Height Adjustment .....	18
5. UNDERSTAND G516 DISPLAY .....	19
DISPLAY Overview .....	19
DISPLAY Console .....	19
DISPLAY Parameter Window .....	20
DISPLAY Specifications .....	21
DISPLAY Button Function .....	21
6. OPERATE THE PRODUCT .....	22
OPERATION Safety Operating Area .....	22
OPERATION The Push Brake Sytem .....	23
OPERATION Stretching Your Calf Muscles .....	24
OPERATION Mounting/Dismounting the Bike .....	25
OPERATION Safety Tips For Operating the Bike .....	26
OPERATION Start Screen .....	27
OPERATION Quick Start Mode .....	27
OPERATION User Information Settings .....	28
OPERATION Operating Instructions .....	29
OPERATION COOL DOWN .....	29
OPERATION Stop Exercise .....	29
OPERATION Workout Summary .....	30
OPERATION Auto Power Off Function .....	30
OPERATION User Preference Settings .....	31

# G516 OWNER'S MANUAL CONTENTS

7. ABOUT HEART RATE DETECTION .....	33
HEART RATE Telemetry .....	33
8. MICRO INVERTER .....	34
MICRO INVERTER Important Safety Instructions .....	34
MICRO INVERTER Cautionary Messages .....	34
MICRO INVERTER Electronic Specifications .....	36
MICRO INVERTER Circuit Board & Product Settings .....	37
9. MAINTENANCE .....	39
MAINTENANCE Safety Precautions .....	39
MAINTENANCE Error Messages .....	40
MAINTENANCE Schedule .....	41
MAINTENANCE Task List .....	42
MAINTENANCE Maintenance Log .....	43
10. ACCESSORIES .....	44
ACCESSORIES Standard .....	44
ACCESSORIES Option .....	45
11. APPENDIXES .....	47
APPENDIXES Technical Specifications .....	47
APPENDIXES Wiring Diagram .....	48
APPENDIXES Exploded Diagram .....	49
APPENDIXES Product Disassembly .....	50

# 1. INTRODUCTION

Congratulations on the purchase of a high quality SportsArt product, the G516 Eco-cycle. Constructed of high quality materials and designed for years of reliable performance, this product was made for full commercial use.

Before this product is assembled or operated, we recommend that you familiarize yourself with this manual. Understanding the correct assembly and operation of this product will help ensure that exercisers obtain their fitness goals safely and successfully.

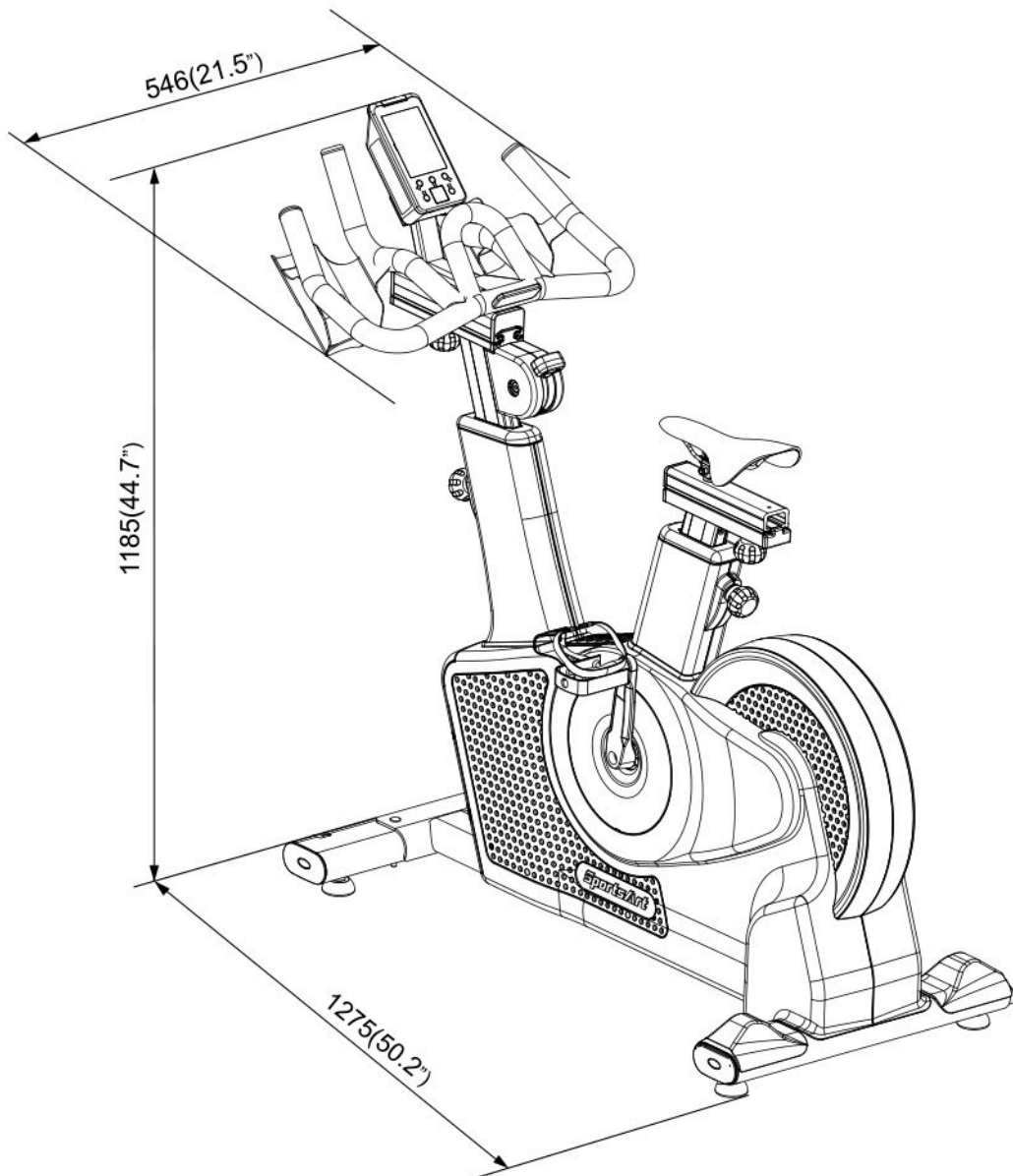

## 2. SAFETY PRECAUTIONS

This product was designed and built for optimum safety. However certain precautions apply during the use of this product. Please note the following safety precautions:

- To reduce the risk of personal injury, read and understand all the instructions before using this product.
- Make sure the product is installed and operated as instructed in this manual. Be careful when mounting and dismounting the unit. The product shall be disconnected from its power source during service and installed and when replacing parts.
- Use this product only for the intended use described in this manual.
- Check the product before every use. Make sure all parts are assembled, and all fasteners are tightened. Do not use the product if it is disassembled in any way.
- Do not leave your device unattended while in use.
- Assemble and operate the product on a solid, level surface. Do not use outdoors or near water (including swimming pools and saunas) and should not be used where aerosol (spray) products or oxygen are used. Do not operate on a blanket or near flammable materials.
- Keep all air ventilation areas free of blockage. Never drop or insert into any opening.
- This equipment should be positioned away from walls to avoid injury due to falls. Be sure that the back of the equipment has at least six to seven feet of clearance from a ledge, wall or window. The power supply and wiring should be located away from walking paths or taped to prevent tripping when stepping on or off of the equipment.
- Wear appropriate workout clothes, don't wear loose clothing, tie all long hair back, wear shoes with rubber or high traction soles, don't wear shoes with leather soles/high heels or barefoot use this product.
- Never place liquids of any type directly on the unit, except in a bottle holder or accessory tray. Lidded containers are recommended.
- Keep away from moving parts. Moving parts may or may not stop immediately if an object becomes caught or impedes normal motion.
- Never operate this product if it has been damaged in any way. If it is not working properly, if it has been dropped or damaged, or dropped into water, contact a service technician for repairs.
- Do not use accessories or parts that are not specifically recommended by the manufacturer (SportsArt). Such parts might cause injuries or cause the unit to fail and void the warranty. We will not be responsible for any safety issue that arises due to the misuse of accessories or parts. At the same time, we will terminate the warranty terms of this equipment.

## 2. SAFETY PRECAUTIONS (CONT.)

- Unpack and verify contents of boxes according to the list of parts to check if any parts are missing. If the product is damaged or missing, contact your SportsArt representative to find out all the materials that were damaged during shipping. (Note: Transport damage is the responsibility of the carrier.)
- This product is not intended for use by persons (including children 12 or younger) with reduced physical, sensory, or mental capabilities, or by people who are otherwise deficient in product knowledge or experience. If such people use this product, they should be given training and be supervised at all times by someone responsible for their safety.
- CAUTION : The heart rate system is for reference only, if you feel any pain or any abnormal feeling, please stop Exercise and consult your doctor immediately.
- Consult your physician before starting a workout or training program. It is recommended that you undergo a complete physical examination. Have your doctor review your training and diet programs to advise you of a workout routine you should adopt.
- WORK within your recommended exercise level. DO NOT work to exhaustion.
- Before using this equipment to exercise, always do stretching exercises to properly warm up.
- Always unplug this appliance from the electrical outlet immediately after using and before cleaning.
- WARNING! Only qualified technicians should be allowed to contact electrical components such as circuit boards. Some components carry an electrical charge even after use has been discontinued or the product has been unplugged. For products with power cords, turn off unit power, wait 10 minutes, then disconnect the power cord from the power socket. For products without power cords, let the unit sit without use for 10 minutes. Only after taking such precautions should covers be removed and electrical components be accessed.
- Do not attempt to drag or carry this unit by the power cord. Keep the power cord away from heated surfaces.
- Do not attempt to modify the plug provided with this product. Proper power supply must be provided. If the plug does not fit an outlet, contact a qualified electrician to inspect or modify power in the facility.
- This product must be grounded. If it should malfunction or breakdown, Improper grounding can increase the risk of electric shock. The product is equipped with a power cord having an equipment-grounding conductor and a grounding plug. The plug must be inserted into an appropriate outlet that is properly installed and grounded in accordance with all local codes and ordinances. Check with a qualified electrician if you are in doubt as to whether the power outlet is properly grounded.
- Noise emission under load is higher than without load.

## 2. SAFETY PRECAUTIONS (CONT.)

- This equipment has been tested and found to comply with the limits for a Class B digital device, pursuant to part 15 of the FCC Rules. These limits are designed to provide reasonable protection against harmful interference in a residential installation. This equipment generates, uses and can radiate radio frequency energy and, if not installed and used in accordance with the instructions, may cause harmful interference to radio communications. However, there is no guarantee that interference will not occur in a particular installation. If the user desires to correct the interference, it is at the user's own expense.
- The recommended minimum operating temperature is 15 degree Celsius.
- The maximum user weight should not exceed 350 lb (160 kg).
- If the product is used in a nominal 120V circuit and the rated current is less than 15A with a grounding plug, use a plug like the one shown below:

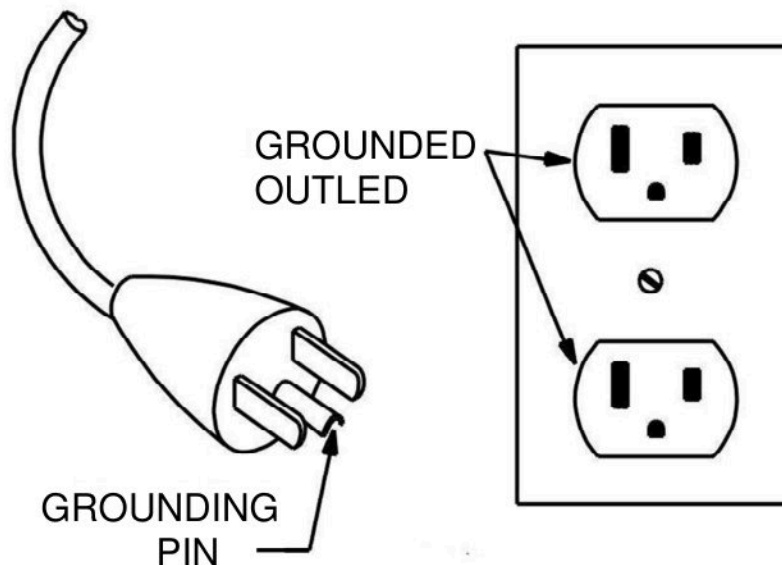

- For countries that do not use 120V as the standard for wall outlets, please comply with certain state and local regulations. Note that only qualified technicians should be allowed to do the wiring.

## **2. SAFETY PRECAUTIONS (CONT.)**

### **MARKINGS**

#### **CAUTION:**

- Read instruction manual before using.
- Do not let children on or near the product.

#### **WARNING:**

- Heart rate monitoring system may be inaccurate.
- Over exercise may result in serious injury or death.
- If you feel faint, stop exercising immediately.
- Use the stationary training equipment in a supervised environment.
- Do not attempt to get off the bike or remove your feet from the pedals until the pedals have completely stopped.
- Press "STOP" to stop flywheel.

### 3. LIST OF PARTS

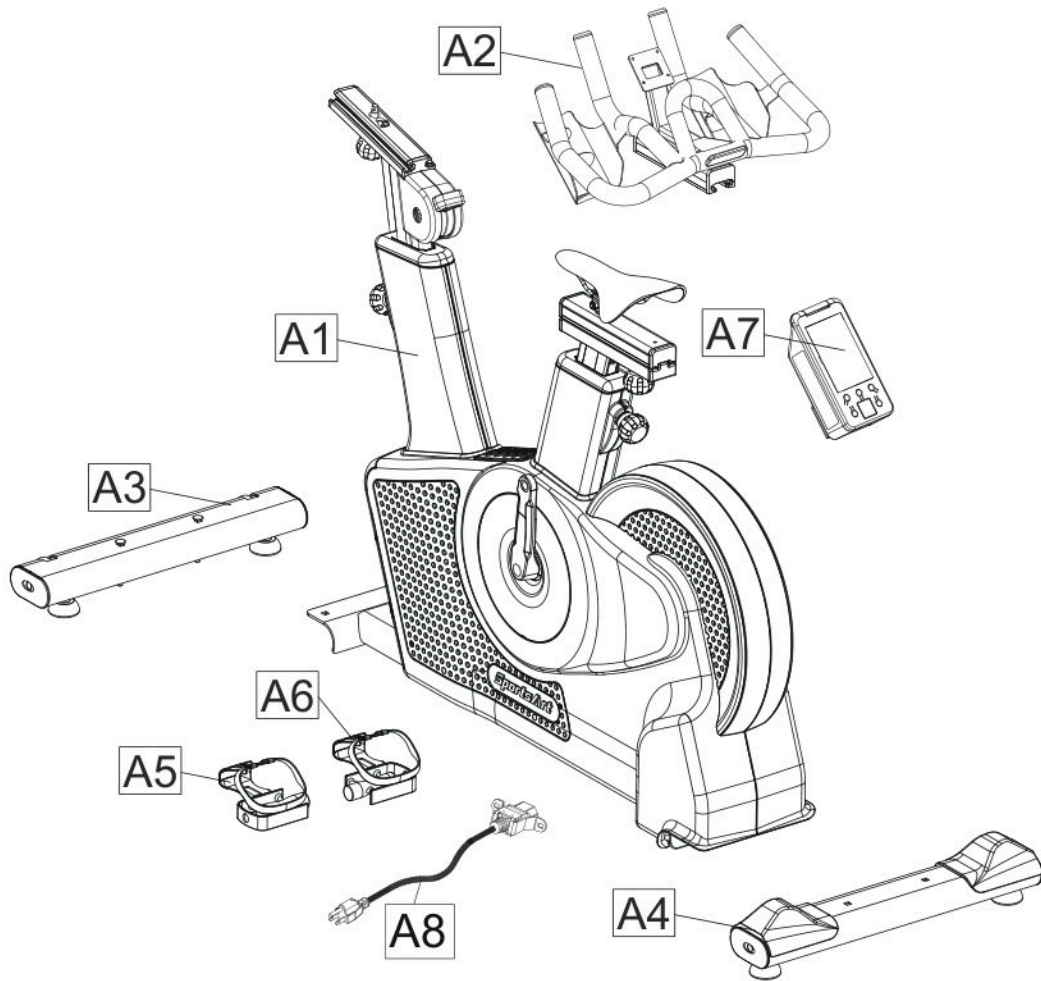

Assembly Parts					
No.	Name	Qty.	No.	Name	Qty.
A1	Main frame	1	A6	Right pedal	1
A2	Handlebar	1	A7	Console	1
A3	Front stabilizer tube	1	A8	Power cord	1
A4	Rear stabilizer tube	1			
A5	Left pedal	1			

### 3. LIST OF PARTS (CONT.)

Hardware Kit				
No.	Name	Qty.	Specification	Notes
23	Carriage bolt	2	M8	
24	Retaining plate	1		
25	Inner hex screw	1	M5	
26	Countersunk flat head screw	4	M4 x L10	
27	Covered bushing	1		
28	End cap	1		
29	Philips screw	2	M4*P0.7*L8	
	Double open-end wrench	1	13mm*15mm	
	L-shaped Allen wrench	1		

Components on the Product			
No.	Name	Specification	Notes
50	iron pipe		
51	Hex head screw	M8	
	Double open-end wrench		

## 4. ASSEMBLE THE PRODUCT

Follow instructions below to assemble this product. Note that in this manual the words “left” and “right” are used to refer to the product and its parts. As such, these designations correspond to the “left” and “right” sides of a person in position to exercise on this product. Also, for brevity, the word “screws” or “nuts” is used where washers and other hardware may be involved.

### STEP 1 Install the Stabilizers

- (1) Loosen the screw (51) with open-end wrench to disassemble the iron pipe (50) before installing the rear stabilizer, and then secure the rear stabilizer (A4) with the screw (51).
- (2) Secure the carriage bolt (23) to the front stabilizer tube (A3) using the wrench.

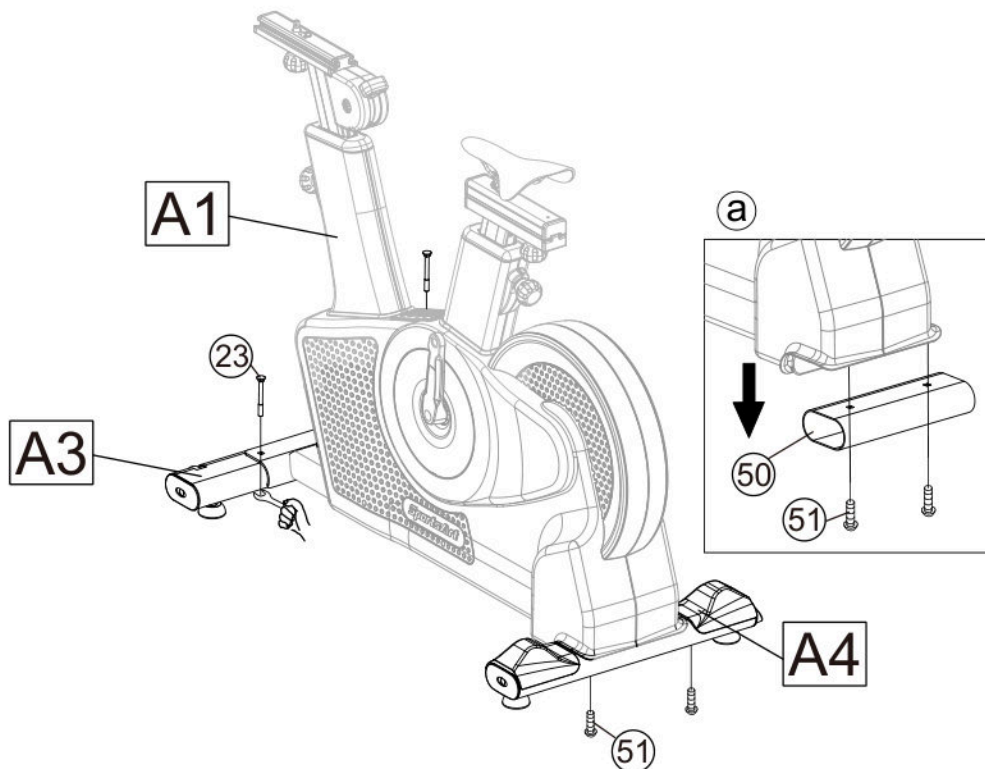

## STEP 2 Install the Pedals

Attach the left and right pedals to the crank arms using the 13\*15 wrench enclosed with the product. Note that the right-side pedal spindle is right-hand threaded, and the left-side pedal spindle is left-hand threaded. Screwing them in the wrong side and/or screwing them with improper tools may damage the pedals.

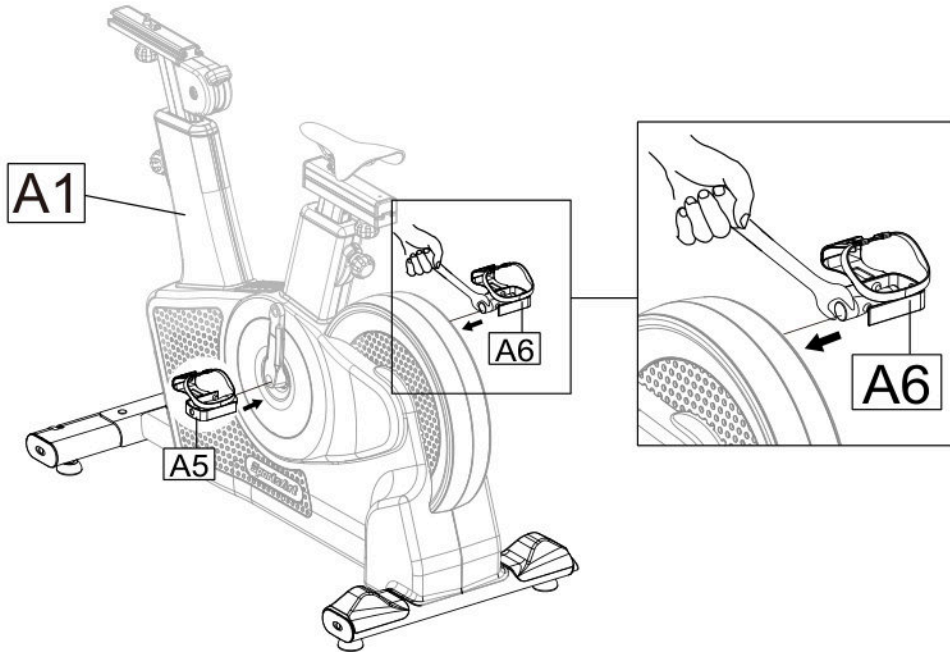

### STEP 3 Install the Handlebar

- (1) Be sure to arrange all the cables and install a covered bushing (27) before installing the handlebar.
- (2) Release the handlebar adjustment pop-pin, slide the handlebar (A2) into the sliding bar mounted on the main frame (A1), and then tighten the pop-pin.
- (3) Thread the cable through the handbar and pull it out from the console mount on the frame.
- (4) Secure the cable by attaching a retaining plate (24), and then tighten the screw (25) to hold the retaining plate (24) into place. Be careful not to pinch the cable when assembling.
- (5) Install the end cap (28) on the handlebar.

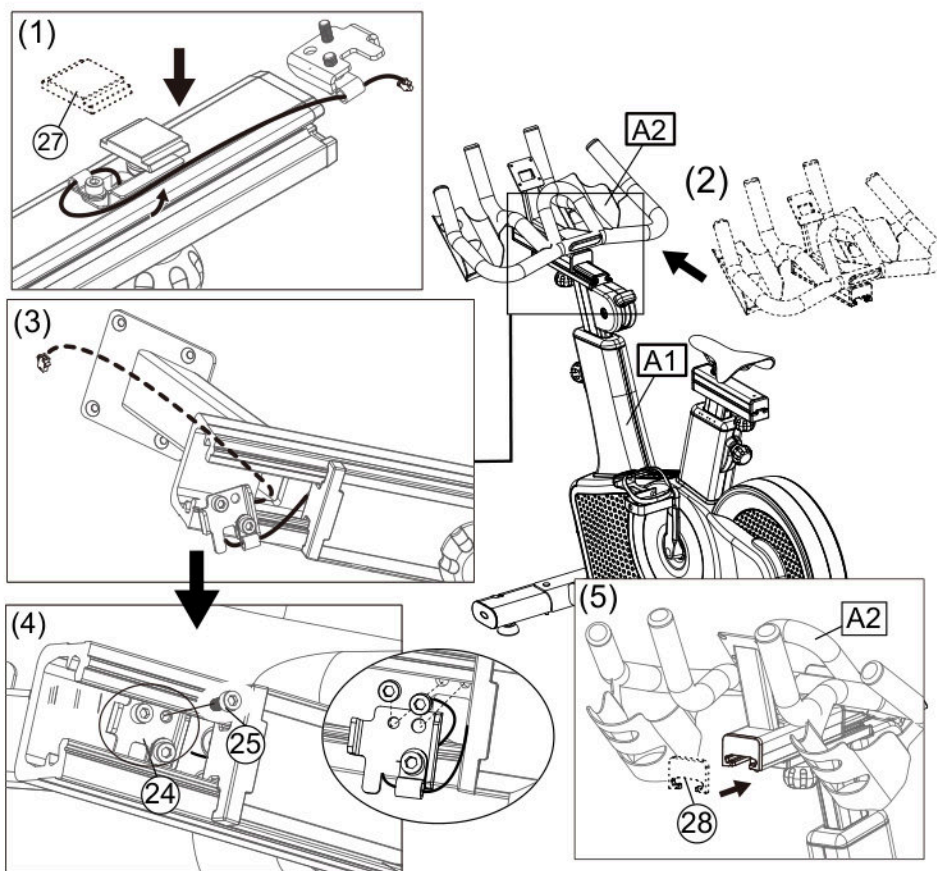

## STEP 4 Install the Console

1. Connect the console cable to the cable coming from the console mount, and tuck the excess cable into the handlebar assembly.
2. Secure the console (A7) to the console mount on the frame with screws(26), and put on the protective cover (27). Be sure to arrange all the cables and tuck them neatly into the opening before tightening the screws.

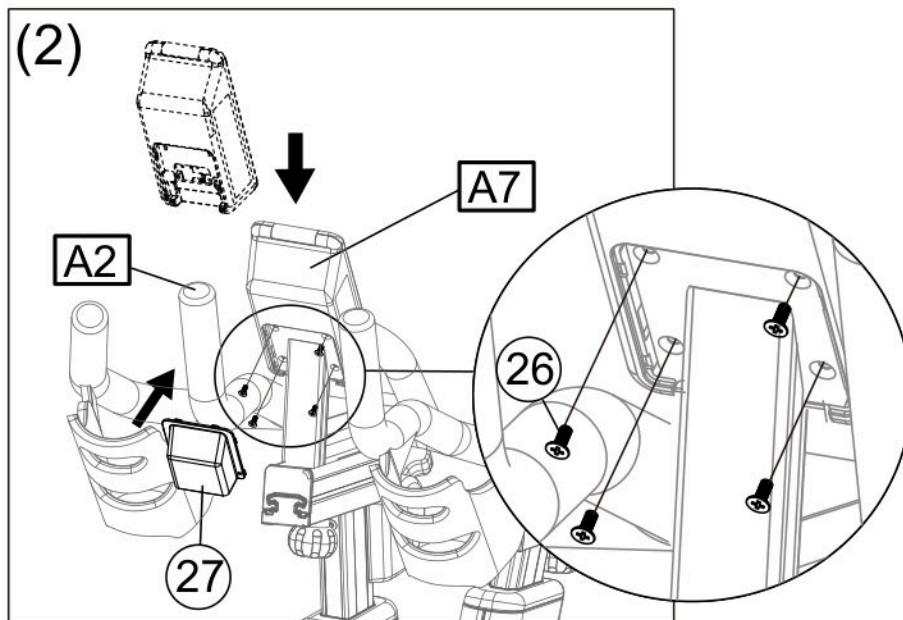
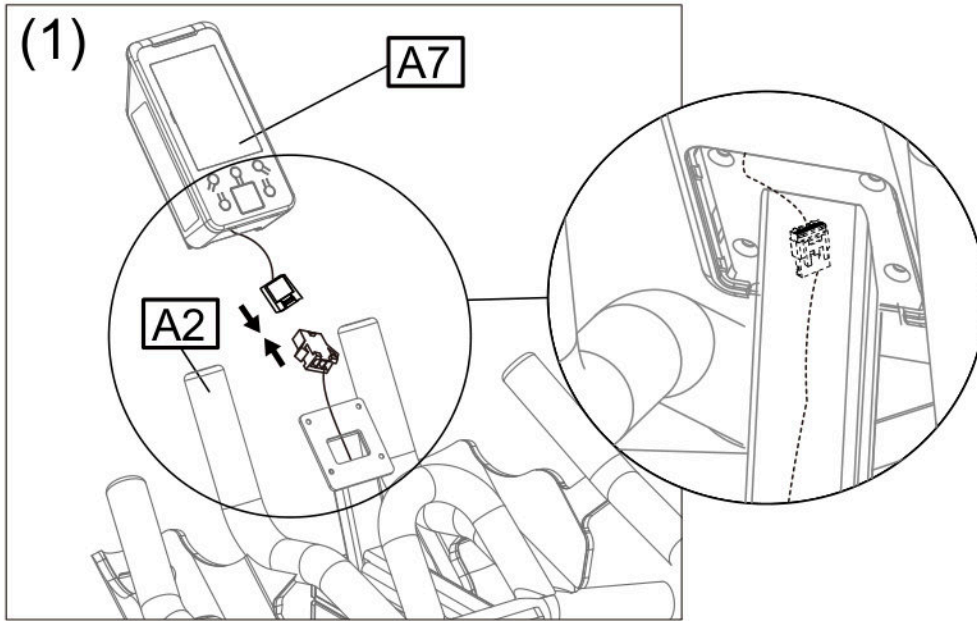

## STEP 5 Moving the Bike

- (1) Stand in front of the bike, grasp the handlebars and tip the bike toward you until the transportation wheels are touching the floor. Roll the bike to the desired location and then gently lower the rear of the bike back to the floor.
- (2) Hold the rear stabilizer and tilt the bike until the transportation wheels on the front stabilizer touch the ground. Roll the bike to the desired location and then gently lower the rear of the bike back to the floor.

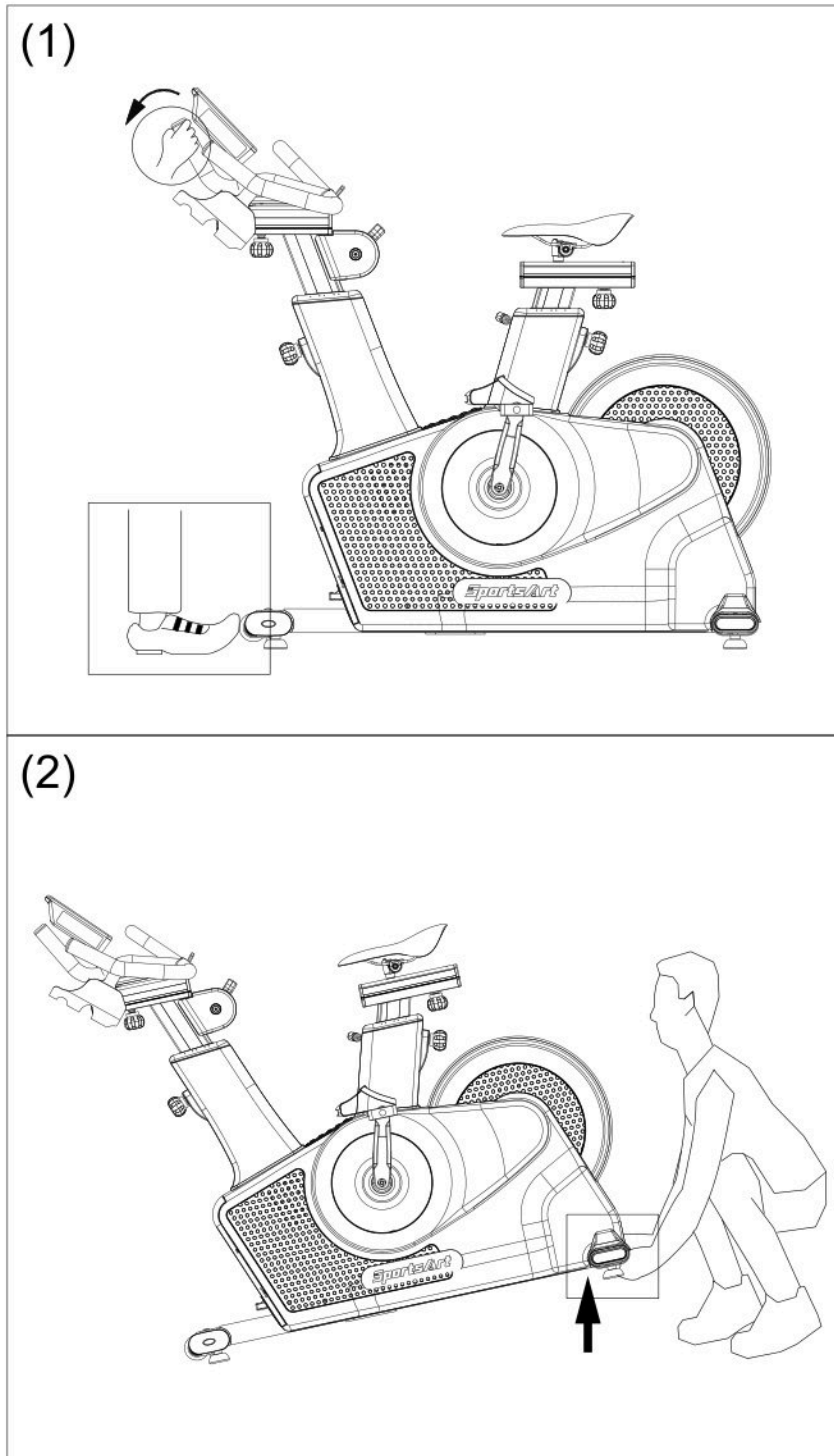

## STEP 6 Leveling the Bike

For the user's safety and the proper functioning of the product, this bike must sit level on a flat floor. If necessary, adjust the levelers by following the instructions.

- (a) Loosen the leveler nut.
- (b) Rotate the leveler foot downward so it firmly touches the floor.
- (c) To secure this position, secure the leveler nut against the product frame.
- (d) Perform functional and performance testing to make sure that the product works as expected.

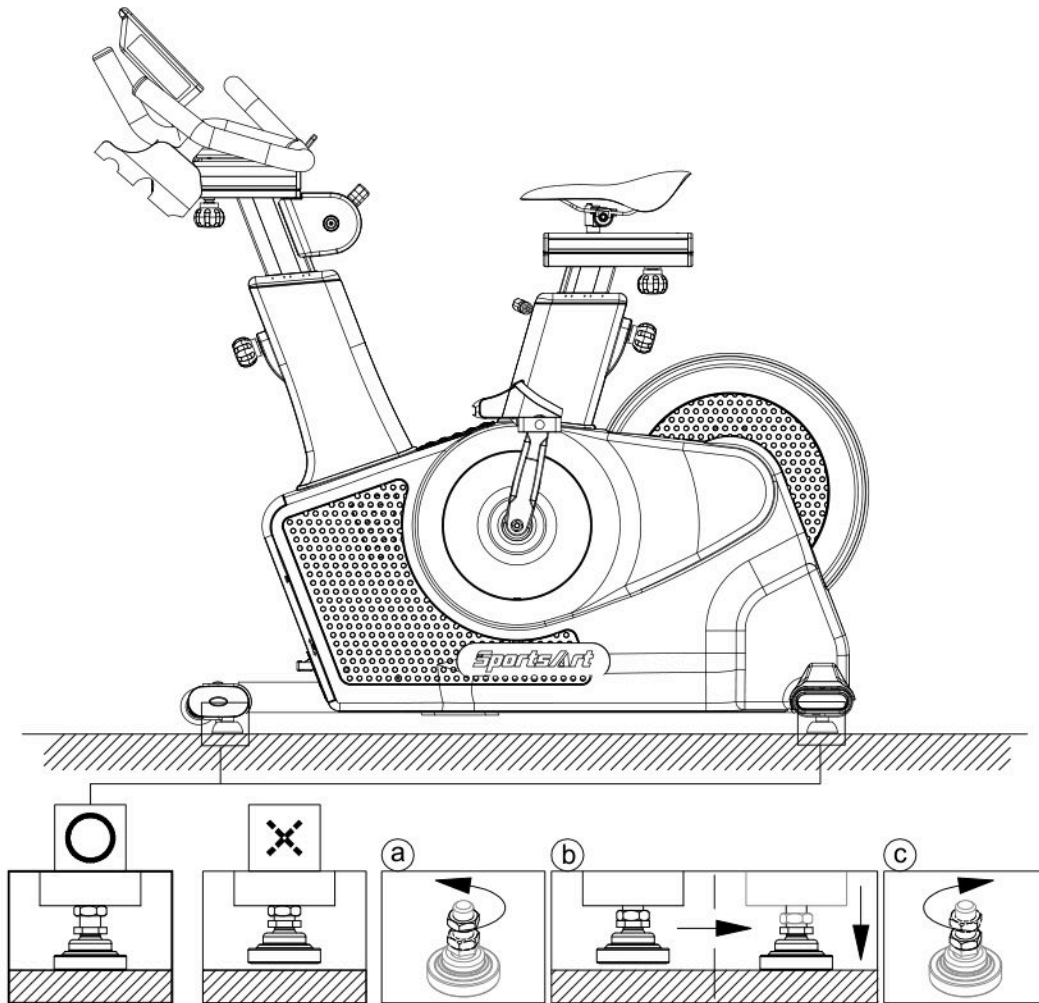

## STEP 7 Install the Power Cord

- (1) Remove the screw (29) from the base of the bike.
- (2) Insert the power cord plug into the connector on the product.
- (3) Plug the power cord (A8) into the outlet and secure the power cord plug into place with the removed screw (29).

Note: the figure below is for reference purposes only.

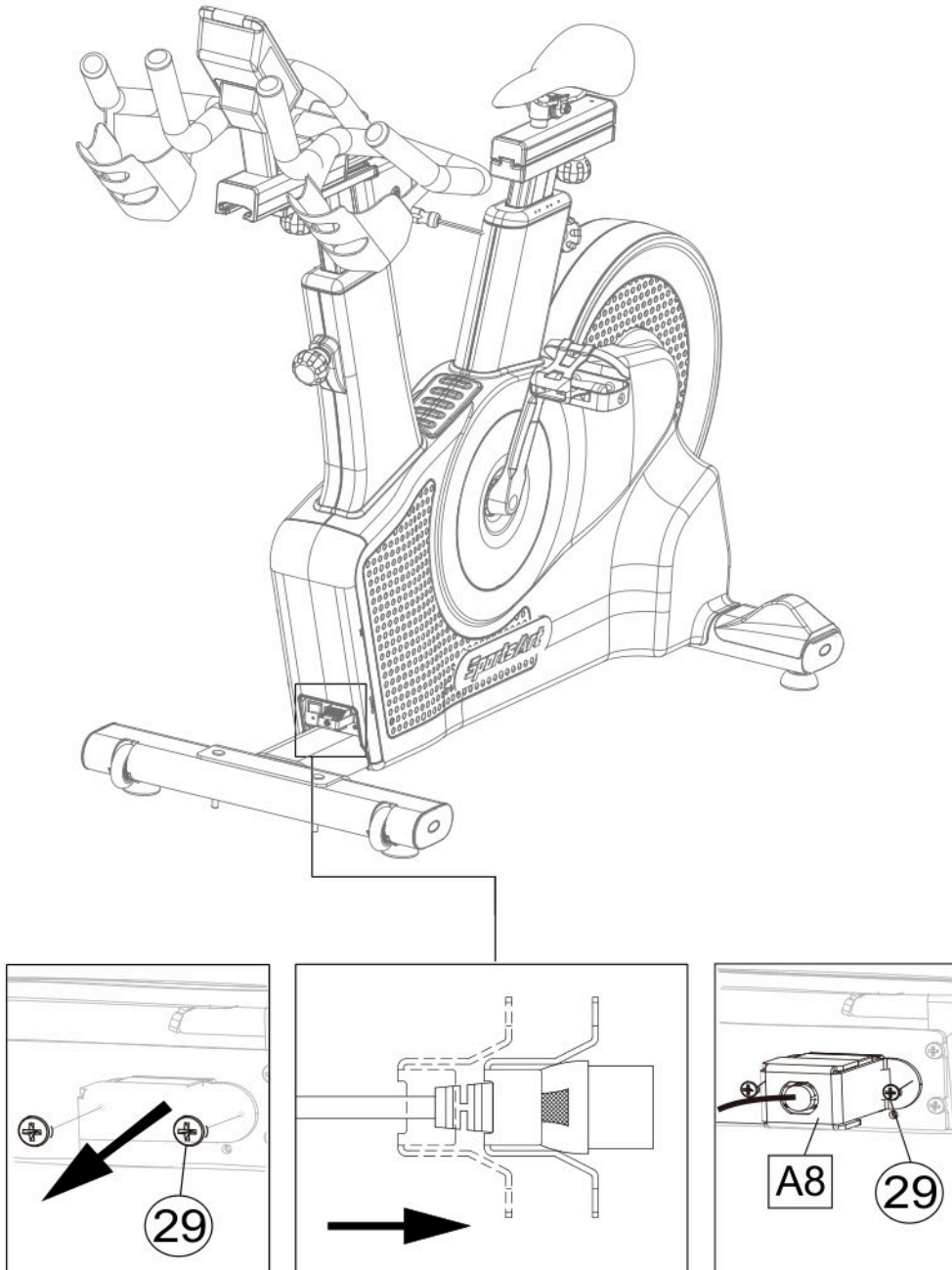

## **STEP 8** Handlebar/Seat Horizontal Position Adjustment

Loosen the handlebar/seat fore-and-aft tension knob by turning the knob counterclockwise. Move the handlebar/seat forward or back to the desired position, then tighten the tension knob by turning clockwise.

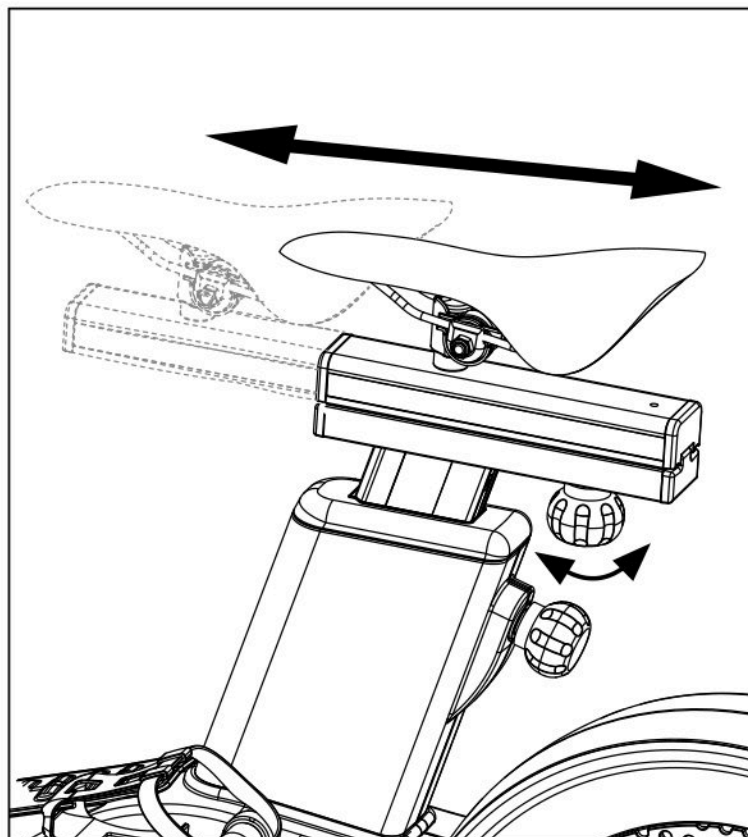
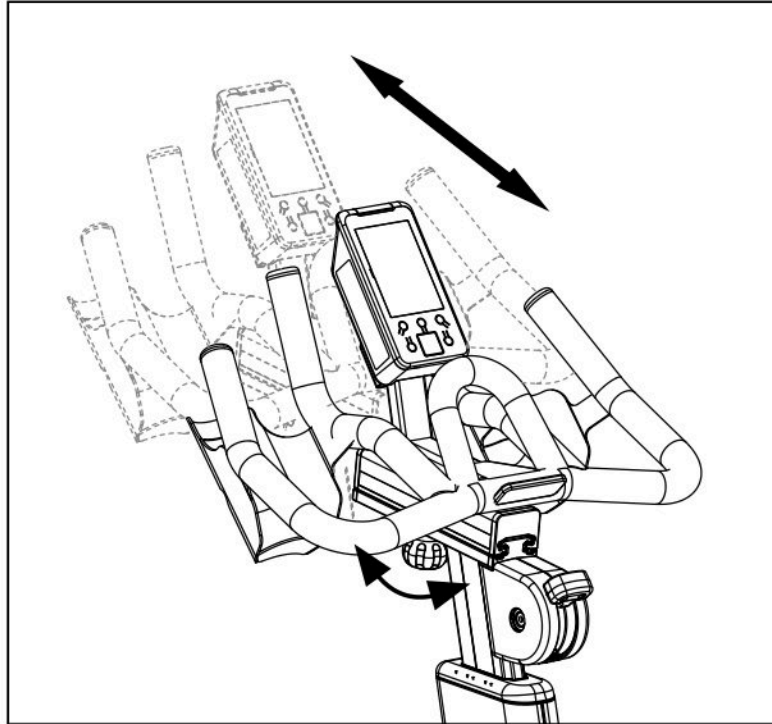

## STEP 9 Handlebar/Seat Height Adjustment

Turn the handlebar/seat height pop-pin counterclockwise and pull out on the pin to release it from its current preset location. Raise or lower the handlebar/seat to the desired height, then gently release the pop-pin and turn clockwise to secure. Be sure to tighten firmly.

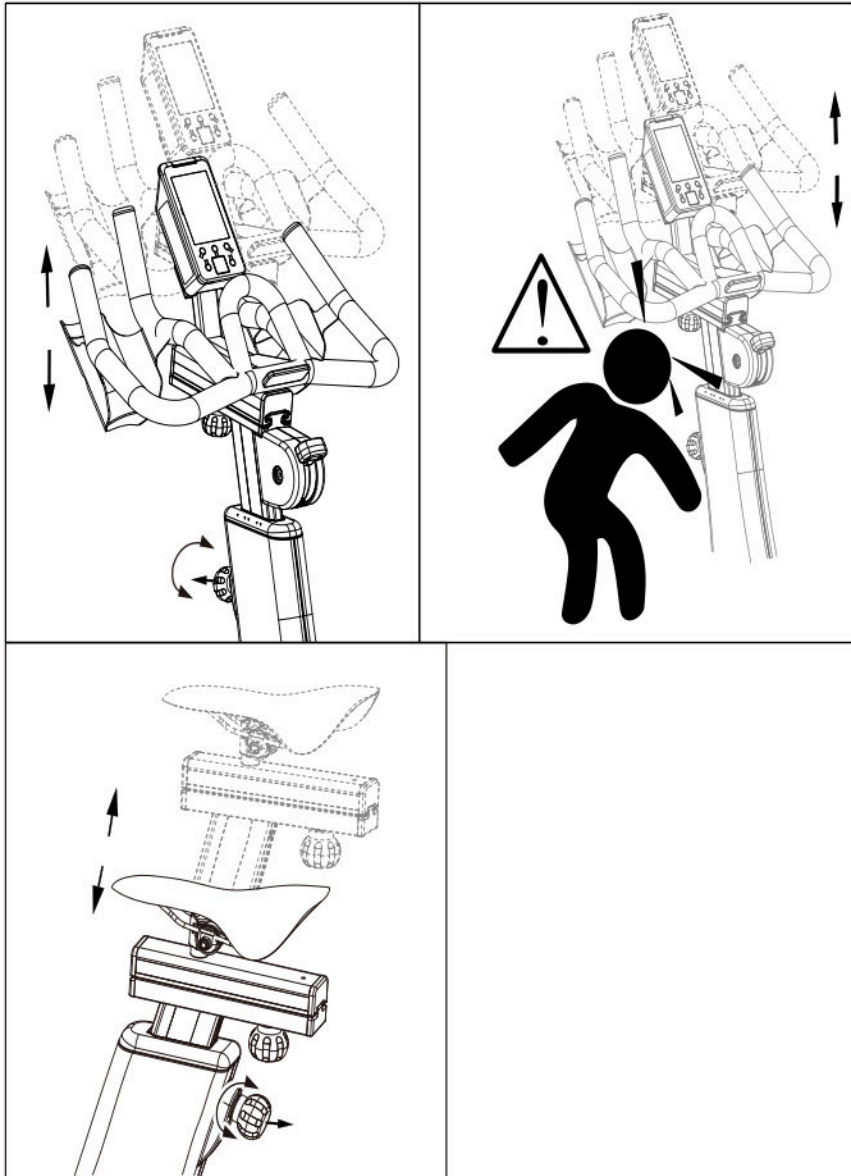

## 5. UNDERSTAND G516 DISPLAY

### DISPLAY Overview

Before using the product, please familiarize yourself with the features on the display so you can fully utilize the product and all it has to offer.

### DISPLAY Console

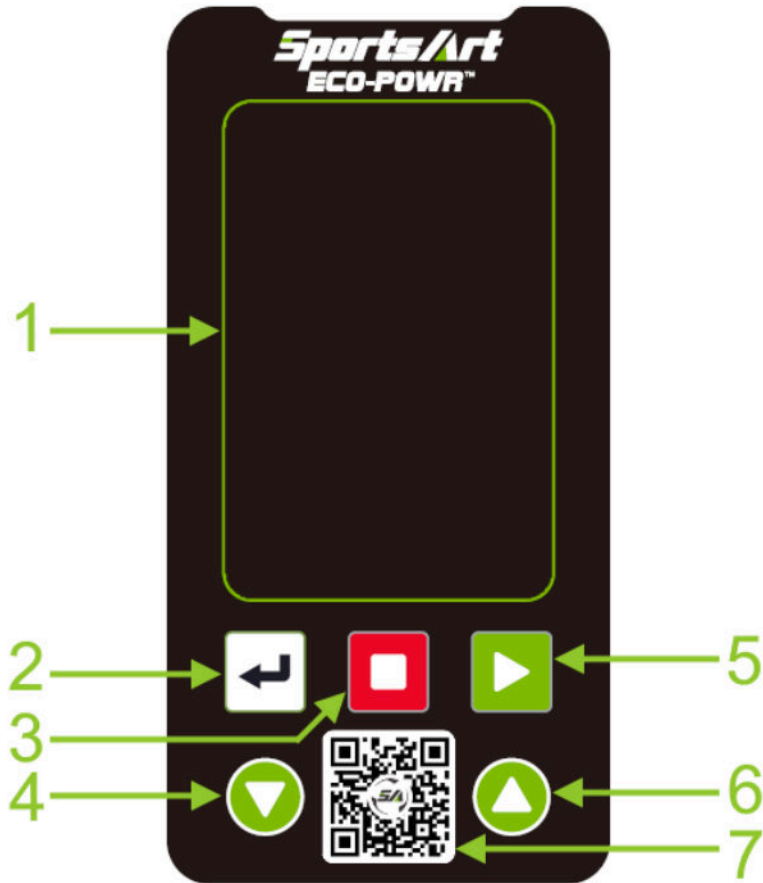

No.	Key Name	No.	Key Name
1	LCD window	5	QuickStart Key
2	ENTER Key	6	Resistance key (▲)
3	End Program Key	7	QR Code
4	Resistance key (▼)		

## DISPLAY Parameter Window

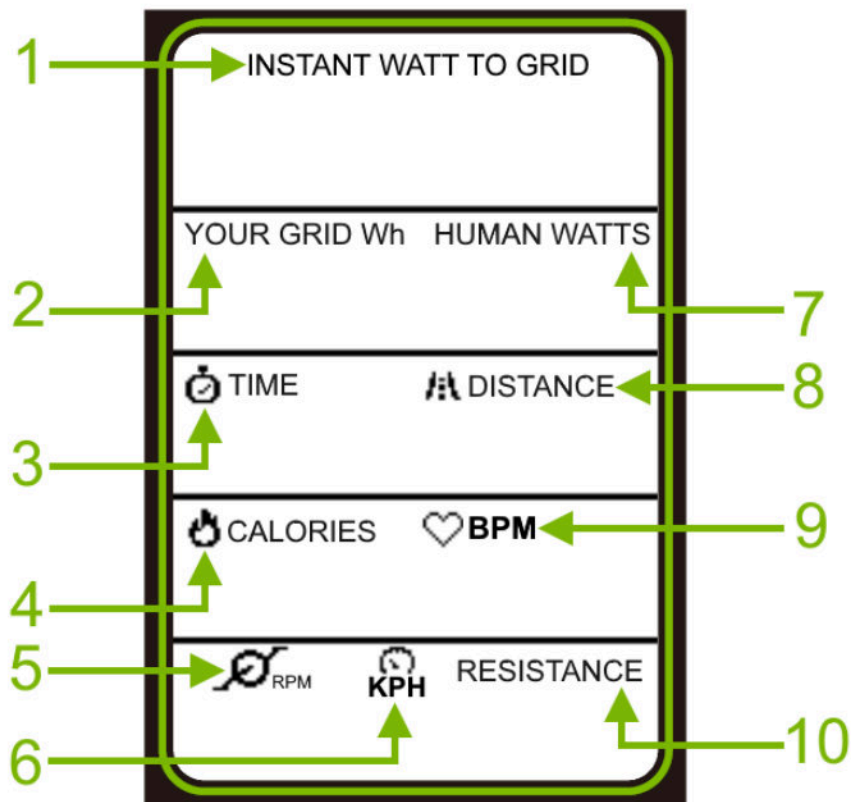





No.	Description
1	Displays Instant Watt To GRID
2	Displays GRID Wh value accumulated
3	Displays the elapsed time of the workout or the remaining time to exercise
4	Displays the calories you have burned during the exercise
5	Displays revolutions per minute (RPM)
6	Displays your actual speed
7	Displays current Human Watts
8	Displays the distance covered or the remaining distance in a workout
9	Displays your heart rate value.
10	Displays your resistance level.

## DISPLAY Specifications

Parameter	Spec.
INSTANT WATT TO GRID	0–270 Watts
YOUR GRID Wh	0–9999 Wh
TIME	0–300 min
CALORIES	0–9999 K-CAL
RPM	0–200
SPEED	0–48.7 MPH or 0–78.0 KPH
HUMAN WATT	0–9999 Watts
DISTANCE	0.00–9999 Mile/Km (display maximum of 2 decimal places)
PULSE	35–220 bpm
RESISTANCE	1–40

## DISPLAY Button Function

Element	Description
	The button has two functions: (1) Set the age and weight of the user. Choose a fitness goal. (2) After the parameter settings are complete, press the key to confirm your selection.
	Press the button to end the workout program, and a Review Summary screen will display. Hold down this button to go back to start screen.
	Press the button to skip the setup, selections, and start the workout immediately
	The button has two functions: (1) Change values (e.g., age, weight, time) (2) During a workout, press the button to increase resistance level one increment. Hold down the button to increase the resistance level at a faster rate
	The button has two functions: (1) Change values (e.g., age, weight, time) (2) During a workout, press the button to decrease resistance level one increment. Hold down the button to decrease the resistance level at a faster rate.

## 6. OPERATE THE PRODUCT

### OPERATION Safety Operating Area

(a) Safety clearance required as shown below. Do not allow people to be near this area when operating.

(b) Noise emission under load is higher than without load.

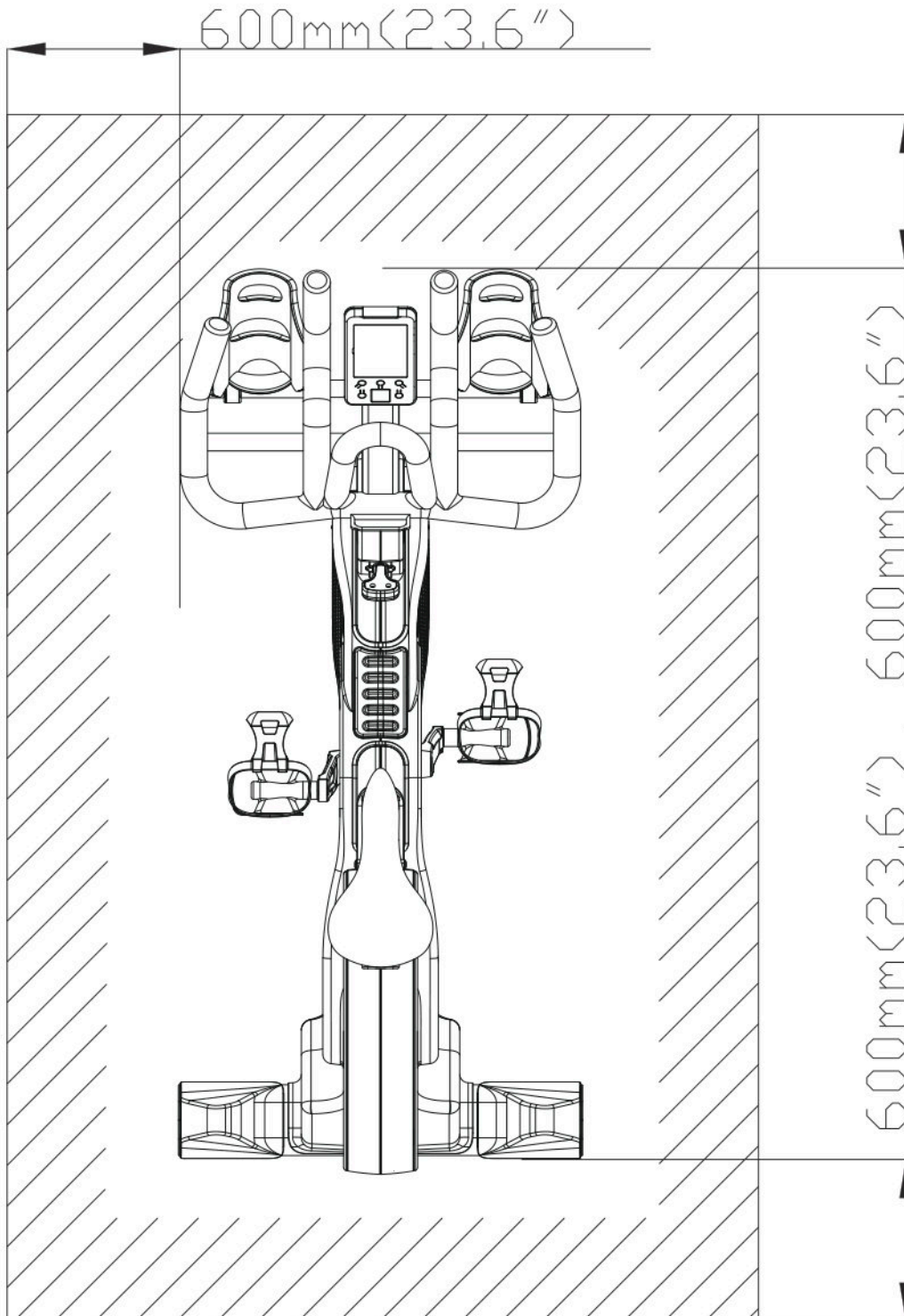

## **OPERATION** The Push Brake System

In case of emergency, you may press directly down on the Push Brake System lever to bring the flywheel to an abrupt stop. Do not remove your feet from the pedals until the bike comes to a complete stop, and do not use your feet to brake. Do not mount/dismount the bike until both the pedals and the flywheel have stopped completely.

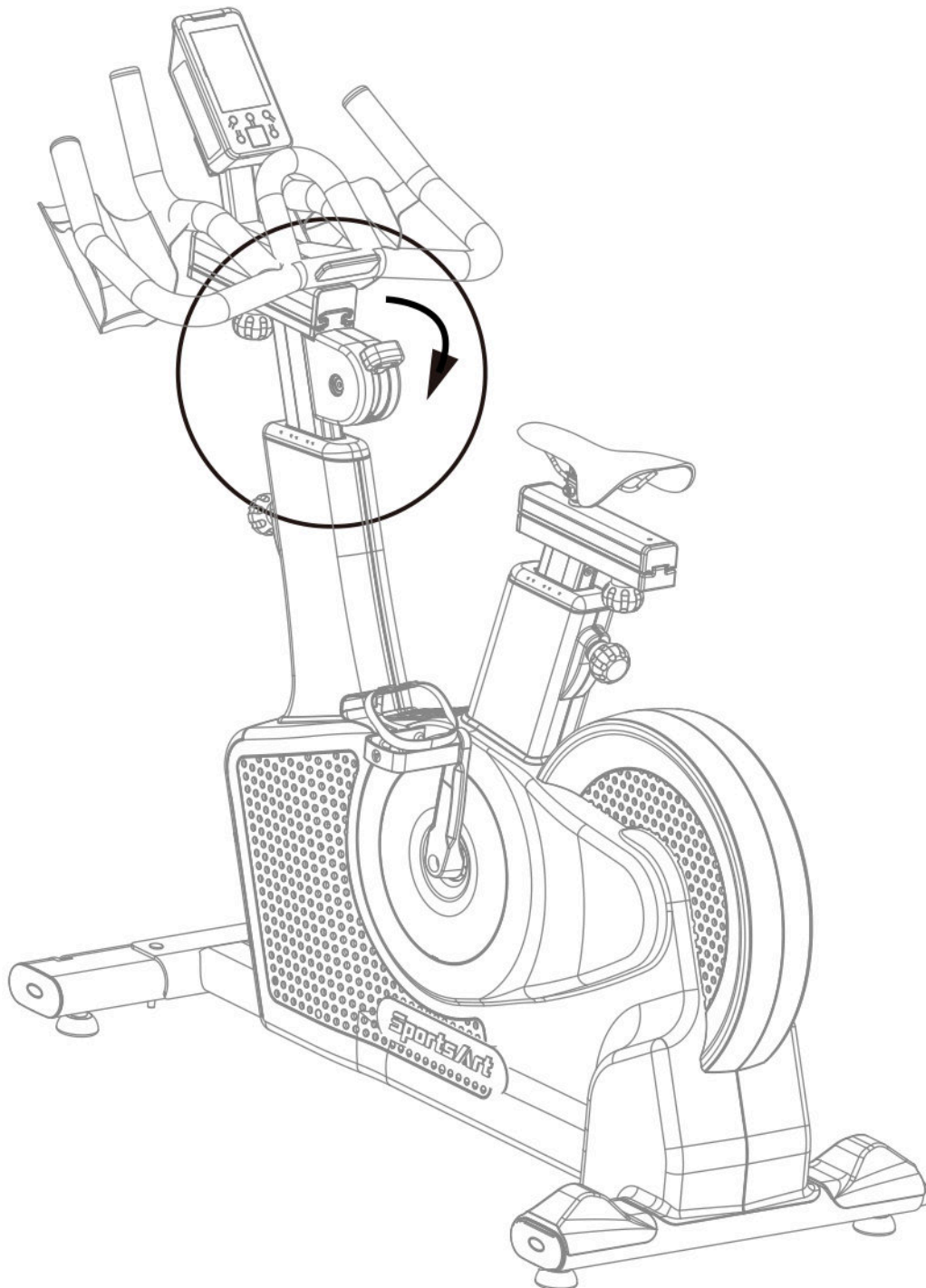

## **OPERATION** Stretching Your Calf Muscles

Standing directly behind the bike, place the sole of one foot against the bottom of the frame, heel down. Stand erect and lean slightly into the bike until you feel a stretch in your calf muscles. Hold the stretch and breathe. Switch legs after 30–60 seconds.

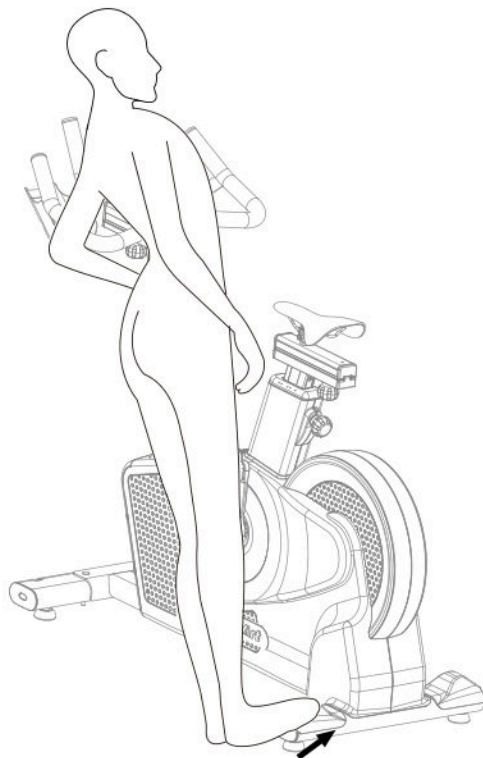
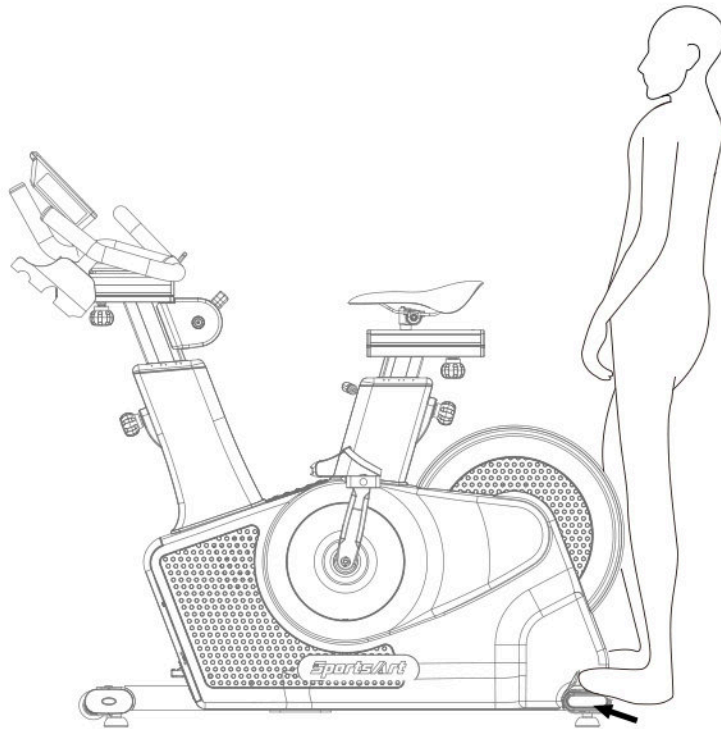

## **OPERATION** Mounting/Dismounting the Bike

---

1. Getting on the bike: Always be cautious when getting on the bike and wait until the pedals have come to a complete stop. Before starting the bike, set the saddle height and sit on the saddle, with your hands holding the handlebars and your feet placed on the pedals.
2. After finishing a workout, wait until the pedals come to a complete stop before taking your feet off the pedals. Do not use your feet to brake.
3. Getting off the bike: Always be cautious when getting off the bike. Always wait until the pedals have come to a complete stop before taking your feet off of the pedals or dismounting.

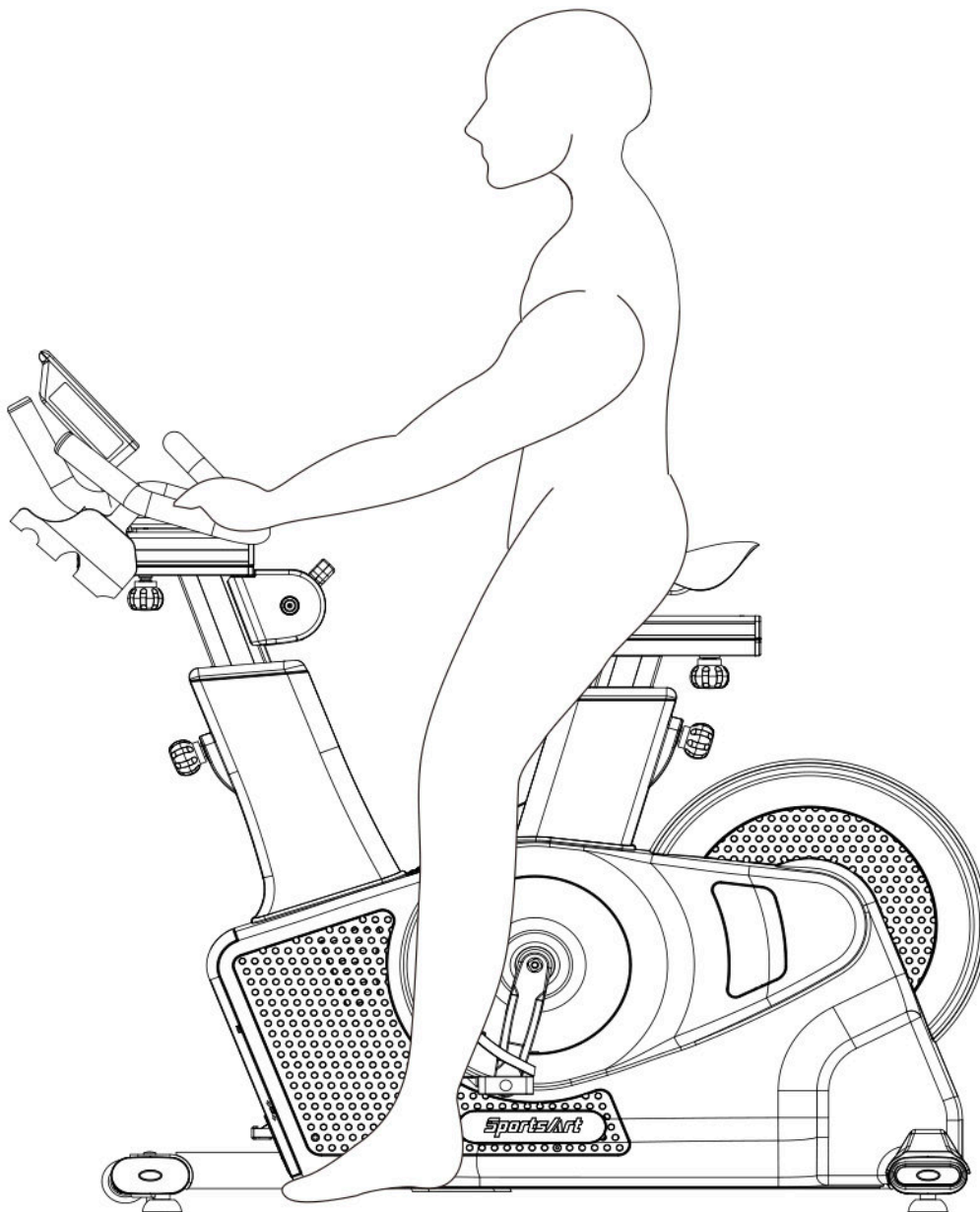

## **OPERATION** Safety Tips For Operating the Bike

---

- (a) If the bike is not operating correctly, making the pedals spin freely without anyone pedaling may increase the risk of injury.
- (b) A good riding posture is illustrated below. Always use the stationary training equipment in a supervised environment.
- (c) Using pedal straps or wearing cycling shoes to keep your feet securely attached the pedals will give you the most efficient pedal stroke.
- (d) Over exercise or improper workout position may result in serious injury.
- (e) Hold onto the handlebar while getting on/off the bike from left/right side.
- (f) This product is intended to build your leg strength and train cardiovascular endurance.

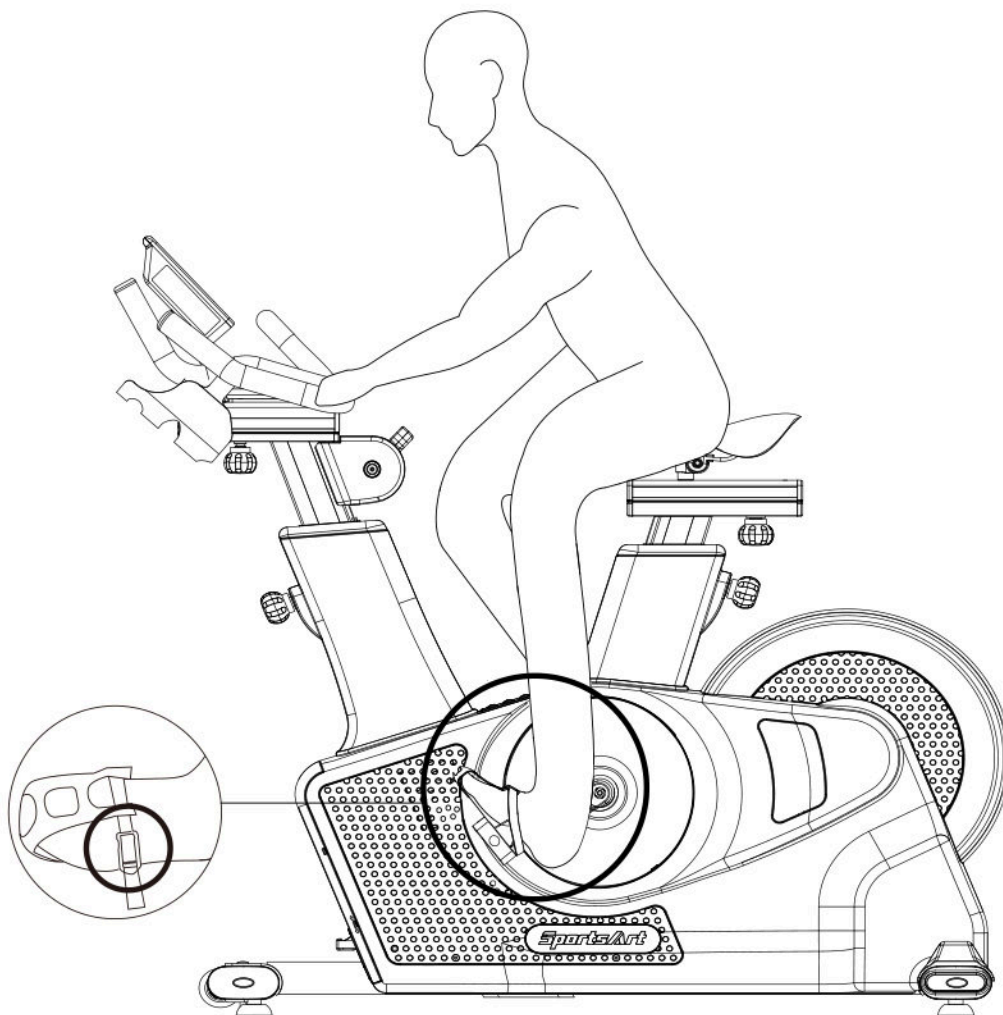

## OPERATION Start Screen

---

Step on the pedal to start the machine. After starting, you will hear a BEEP sound and see the start screen.



## OPERATION Quick Start Mode

---

Press the QuickStart Key to skip the setup, selections, and start the workout immediately.

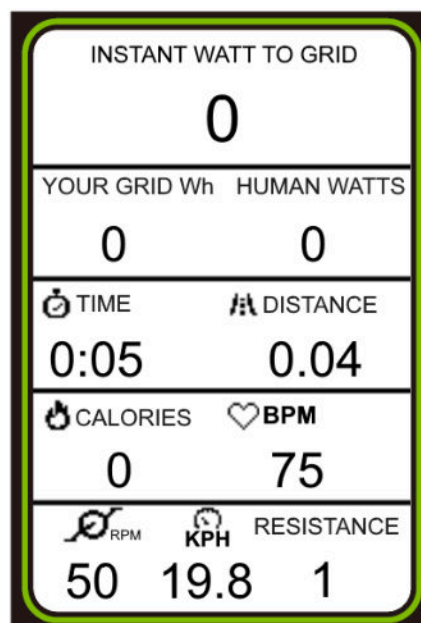

## **OPERATION** User Information Settings

The bike measures your calories burned, target heart rate (using the formula based on your age), workout time, and total distance after you have finished the following settings:





### 1. GOAL Setting

Press the ENTER key to enter the SELECT GOAL screen, then press the <▲/▼> key to select the exercise goal you want.

### 2. WORKOUT GOAL

When you select an exercise goal, set the goal value, and press the ENTER key to complete the setting.

The following is a description of how to set four goals:

Element	Description
	<b>Set &lt;TIME&gt;:</b> Set TIME goal for your workout. The time duration ranges from 5-300min. The default duration is 30min. Press <▲/▼> key to adjust time settings.
	<b>Set &lt;DISTANCE&gt;:</b> Set DISTANCE goal for your workout. The distance ranges from 0.1-99.9 miles/kilometers. The default distance is 2 miles/3 kilometers). Press <▲/▼> key to adjust distance settings.
	<b>Set &lt;CALORIES&gt;:</b> Set CALORIES goal for your workout. The calories ranges from 100-9999 Kcal. The default value is 100Kcal. Press <▲/▼> key to adjust calories settings.
	<b>Set &lt;GRID Wh &gt;:</b> Set GRID Wh goal for your workout. The GRID Wh ranges from 5-100 Wh. The default value is 30 Wh. Press <▲/▼ > key to adjust GRID Wh settings.

### 3. AGE and WEIGHT

When you have completed your goal setting, next set your age and weight.

The following settings are available for age and weight:

#### **Set <AGE>:**

Age ranges from 10 – 90y/o. The default age is 35y/o.

- Press <▲/▼> key to adjust your age.
- Press ENTER Key to confirm and continue to the weight setting.

## **OPERATION** User Information Settings (Cont.)

---

### **Set <WEIGHT>:**

Weight ranges from 50 – 350LB / 20 – 160KG. The default weight is 165LB / 75KG.

- a. Press <▲/▼> key to adjust your weight.
- b. Press ENTER Key to confirm and continue to the workout campaign process.

## **OPERATION** Operating Instructions

---

1. Pedaling resistance is controlled by the resistance adjustment button. There are 40-level adjustable resistance, and resistance adjustments can be made by pressing ▼ to decrease 1 resistance level, or pressing ▲ to increase 1 resistance level. The current resistance level will display on the parameter window.
2. The Instant Watt To GRID shown on the parameter window represents the power generated during workout.
3. During workout, the notification light color will change based on the Instant Watt To GRID produced. The color of the light emitted represents the power generated, see the following table:

Notification light color	White	Green	Cyan	Blue	Purple	Red
Watt(s)	Less than 50	51-70	71-90	91-110	111-150	Higher than 151

4. During workout, you may press the End Program key to stop the workout immediately at any time. After pressing the End Program key the Review Summary screen will display.

## **OPERATION** COOL DOWN

---

If your fitness goals (Time/Distance/Calories/GRID Wh) have been reached, the words “COOL DOWN” will pop up on the screen and start your two-minute cool down to end your workout session.

## **OPERATION** Stop Exercise

---

- (1) If you press the End Program key during workout, the workout values will pause and stop counting and stay at this point.
- (2) When you pause a workout and no operations are in progress for 2 min, the machine will go back to start screen.

## **OPERATION** Workout Summary

---

If you press End Program key to end your workout or finish the cool down period, the words “REVIEW SUMMARY” will pop up on the display and your workout summary will be shown for 15 sec. Press End Program key again to return to the start screen.

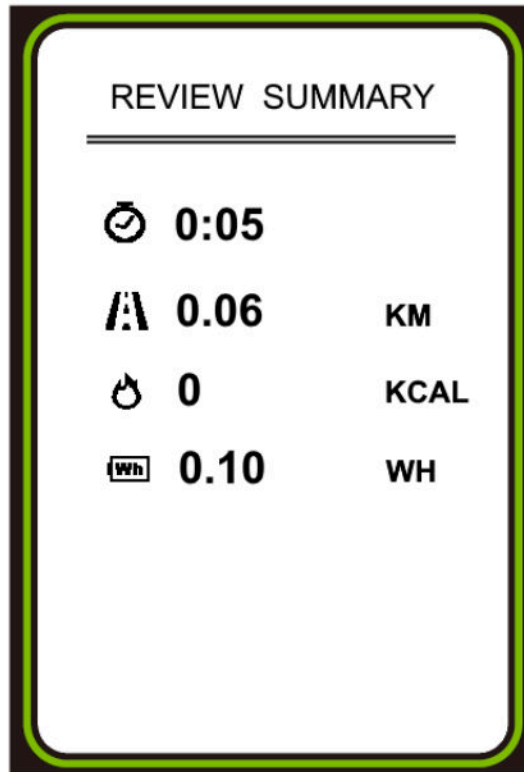

## **OPERATION** Auto Power Off Function

---

If no operations are performed in 30 min on the start screen, the device will auto turn off.

If you want to change auto power off settings, refer to “Sleep Mode Timer Settings” in User Parameter Settings for details.

## **OPERATION** User Preference Settings

---

At start screen, hold down the ENTER key for 3 seconds to enter user preference and component version settings. At any time to return to the start screen press the End Program key.

The setting procedures are as follows:

### **(1) UNITS**

The item “[ UNIT ]” will appear the screen, press the <▲/▼> key to choose the sub-items for [ UNIT ]. Once you’ve selected the desired unit, press the ENTER key to confirm and proceed to the next setting.

### **(2) PROGRAM VERSION**

The item “[ VERSION ]” will appear on the screen, you can press the ENTER key to proceed to the sub-items for [ VERSION ], or press the Quick-Start Key to return to the previous menu.

The sub-items for [ VERSION ] are as follows:

- (a) CTL xxxx : Control board version
- (b) DRV MI-xx-xxxx : MI drive board version
- (c) SA WELL+ x.x.x : SA WELL+ board version (only if the optional SA WELL+ had been purchased)

### **(3) PRODUCT SERIAL NUMBER**

“S/N xxxxxxxx” will scroll across the screen, you can press the ENTER key to proceed to the next setting, or press the QuickStart Key to return to the previous menu.

### **(4) LANGUAGE**

The item “[ LANGUAGE ]” will appear on the screen, press the <▲/▼> key to choose the sub-items for [LANGUAGE ]. Once you’ve selected the desired language, press the ENTER key to confirm and proceed to the next setting, or press the QuickStart Key to return to the previous menu.

## **OPERATION** User Preference Settings (Cont.)

---

### **(5) SLEEP MODE TIME**

The item “[ SLEEP MODE TIME ]” will appear on the screen, press the <▲/▼> key to adjust the sleep mode time. Once you’ve selected the desired time period, press the ENTER key to confirm and proceed to the next setting, or press the QuickStart Key to return to the previous menu.

Note: If the timer is set less than 5 minutes, sleep mode will be deactivated. You may select among 5-60 min or OFF. The default sleep mode time is 30 min.

### **(6) TOTAL TIME**

The item “[ TOTAL TIME ]” will appear on the screen, you can press the ENTER key to proceed to the next setting, or press the QuickStart Key to return to the previous menu.

### **(7) TOTAL DISTANCE**

The item “[ TOTAL DISTANCE ]” will appear on the screen, you can press the ENTER key to proceed to the next setting, or press the QuickStart Key to return to the previous menu.

### **(8) TOTAL ENERGY**

The item “[ TOTAL ENERGY ]” will appear on the screen, you can press the ENTER key to proceed to the next setting, or press the QuickStart Key to return to the previous menu.

### **(9) BRIGHTNESS**

The item “[ BRIGHTNESS]” will appear on the screen, press the <▲/▼> key to adjust the brightness. Once you’ve selected the desired brightness, press the ENTER key to proceed to the next setting, or press the QuickStart Key to return to the previous menu.

### **(10) BEEP SOUND**

The item “[ BUZZER ]” will appear on the screen, press the <▲/▼> key to toggle between ON or OFF. Once you’ve made your selection, press the ENTER key to confirm and return to the start screen, or press the QuickStart Key to return to the previous menu.

## 7. ABOUT HEART RATE DETECTION

Heart rate detection functions are selected at the time of purchase. Not every product has every type of heart rate detection. The following explains factors that influence the performance of two of the most common types of heart rate detection devices.

### HEART RATE Telemetry

---

The words “telemetry heart rate” refer to the detection of heart rate via a device worn on the exerciser and transmitted over the air to a circuit board built into the product. Telemetry heart rate devices are commonly worn on the exerciser’s chest, where the pulse is strongest and relatively easy to detect.

The following explains conditions that affect the performance of the telemetry heart rate function in all products.

- The telemetry heart rate transmitter emits a wireless 5 kHz signal that is harmless to the human body. Keep a distance within 60cm between the heart rate receptor and the transmitter to achieve stable connection.
- If the battery is too low, the receiving distance may be shortened or there will be no reception.
- Secure the telemetry heart rate transmitter on your chest so that it stays in place without making you feel uncomfortable. Moisten the skin for better contact.
- Because the telemetry heart rate signal varies in strength from 20 Hz to 20 KHz, environmental interference can block signal reception. Physical vibration and electronic devices, including stereos, TVs, and even fluorescent lights, can interfere with signal reception. For best results, install the product in an area free from such interference.
- Space the product apart by at least 39 inches (100 cm) to avoid having the heart rate value from one exerciser appear on a neighboring product.

**This product is NOT equipped with hand-grip heart monitor.**

## 8. MICRO INVERTER

### MICRO INVERTER Important Safety Instructions

---



#### CAUTION

These servicing instructions are for use by qualified personnel only. To reduce the risk of electric shock, do not perform any servicing other than that specified in the operating instructions unless you are qualified to do so.

#### PRUDENCE!

Ces instructions d'entretien sont uniquement destinées à un personnel qualifié. Pour réduire le risque de choc électrique, ne pas effectuer un autre service que celui spécifié dans les instructions de fonctionnement, à moins que vous soyez qualifié pour le faire.

To lower the risks involved in the assembly and operation of this inverter, please carefully note the meaning of the following warning symbols, abide by their messages, and thoroughly read these instructions.



This WARNING symbol indicates a risk of electric shock. Please use extreme caution when processing the procedure.



This CAUTION symbol identifies an improper operation that could result in critical safety issue or damage to the user or devices.

### MICRO INVERTER Cautionary Messages

---

To lower the risks involved in the assembly and operation of this inverter, please follow the intent of these messages.



#### CAUTION

Plates are live. Disconnect unit before servicing. No user serviceable parts inside. Refer servicing to qualified service personnel.

#### ATTENTION!

Les plaques sont à nu. Débrancher l'appareil avant son entretien. Aucune pièce n'est réparable par l'utilisateur. Faire appel à un réparateur qualifié pour toute intervention de dépannage.



**WARNING**

Power fed from more than one source. Each circuit must be individually disconnected before servicing. Do not remove cover until 5 minute after disconnecting all sources of supply.

**AVERTISSEMENT!**

L'alimentation provient de plus d'une source. Chaque circuit doit être coupé avant toute intervention de dépannage. Attendre 5 minutes avant de retirer le couvercle une fois toutes les sources d'alimentation coupées.



**CAUTION**

Perform all electrical installations in accordance with all applicable local electrical codes and the National Electrical Code (NEC), ANSI/NFPA 70.

**PRUDENCE!**

Effectuer toutes les installations électriques en conformité avec les règlements locaux en vigueur et du Code National de l'Electricité (NEC), ANSI/NFPA 70.

## MICRO INVERTER Electronic Specifications

Input Data(3 Phase AC)	
Input power source	3 Phase permanent-magnet generator
Maximum input voltage	140V(line-to-line voltage)
Nominal operating voltage range	55-125V(line-to-line voltage)
Maximum input current	7A(line current)
Output Data(single phase AC)	
Maximum continuous output power	220W
Output power factor rating	>0.9
Nominal voltage(Operating range)	120VAC(105.6-132.0V) (for USA) 230VAC(184.1-240.0V) (for EU)
Maximum continuous output current	2.0A(for 120V) (for USA) 1.3A(for 230V) (for EU)
Normal output frequency(Operating frequency range)	60Hz(59.3~60.5Hz) (for USA) 50Hz(47.4~50.1Hz) (for EU)
Utility interconnection voltage and Frequency trip limits and trip times	0.16s (for USA) 0.2s(for EU)
Maximum units per branch	7 (for USA, 15A branch system) 9 (for EU, 10A branch system)
Output controlling method	The LEVEL command of panel controller
Others	
Normal operation temperature range	+5°C~+35°C
Storage temperature range	+5°C~+40°C
Enclosure Rating	Type 1:"indoor use only"
Application	For SportsArt device only

## **MICRO INVERTER** Circuit Board & Product Settings

### **Frequency setting:**

MICRO INVERTER can detect the frequency automatically without setting.

### **Connecting to grid power:**

After MICRO INVERTER is installed into Eco-Powr products, the power can be linked to grid power through the product power cord, as shown in the following figure. Attention: it is necessary to cover the power cord and product connecting area with a metal cover. Unplug the power cord from the wall outlet before pulling the plug from the product. If the plug is pulled while it is connected to the power grid, it might cause the electric arc and damage the plug

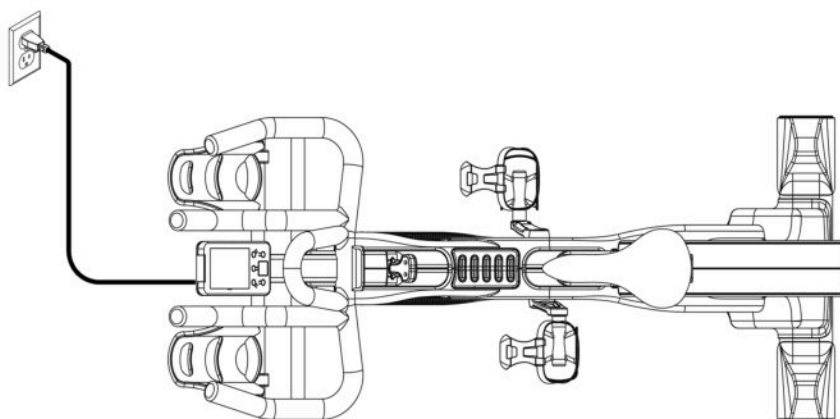

### **The number of products can be linked to a power circuit line:**

The max wattage output of MICRO INVERTER is 220W. Pay attention to the electricity capacity limit (the rating of over-current protective device) to avoid overload. Different area voltage limits are shown as the following table.

Local Grid voltage	The rating of the circuit	Number of products
230V	10A	9
220V	10A	8
120V	15A	7
110V	15A	6

## MICRO INVERTER Circuit Board & Product Settings (Cont.)

A typical alert message figure will pop up on the screen like the one below if the device is not connected to a power source that matches its specifications. Please ensure that the scanning device is connected to the AC power supply (110V/220V).

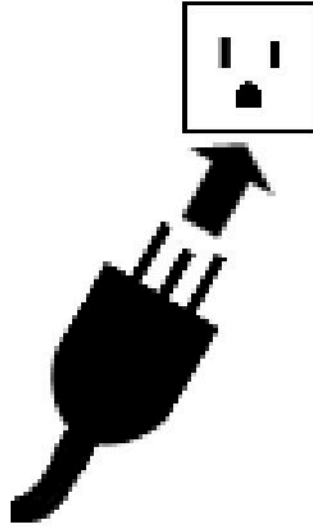

This optional accessory, the SportsArt ECO-POWR Daisy Chain unit connection cord, allows multiple ECO-POWR products to be powered from a single electrical socket.

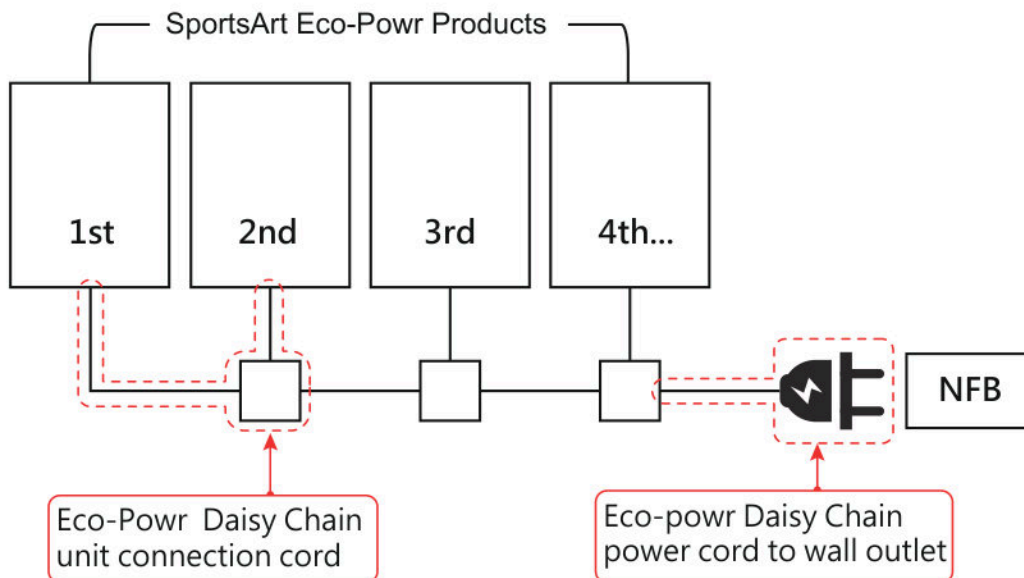

## 9. MAINTENANCE

This section covers maintenance topics, including error messages, along with the presentation of a maintenance schedule, maintenance task list, one-year maintenance log, and Wiring diagram.

### **MAINTENANCE** Safety Precautions

---

- Please follow standard safety precautions when servicing this product.
- Electronic components can carry an electrical charge even after the product has been turned off. For safety, turn off unit power. Wait five minutes to allow capacitors to discharge. Then disconnect the power cord from the wall socket (if applicable.) Only after such steps have been completed should covers be removed and electronic components accessed.
- Unplug the product and wait ten minutes before performing maintenance.
- Do NOT use a damp towel to clean the product and do not perform the following maintenances.
- Do NOT use cleaners with alcohol, ammonia, or other damaging chemicals. The use of such chemicals can damage the product and void the warranty. Never spray or pour any liquid directly onto the product. Doing so can damage electronic components and void the warranty.
- Use a clean, lint-free towel, dampened with a mixture of Simple Green® all-purpose cleaner, to thoroughly clean the handlebar and the console.
- This product has moving parts that can be hazardous. Exercise caution when maintaining, operating, or moving this product.
- Do not use accessories or parts that are not specifically recommended by the manufacturer (SportsArt) . Such parts might cause injuries or cause the unit to fail and void the warranty. We will not be responsible for any safety issue that arises due to the misuse of accessories or parts. At the same time, we will terminate the warranty terms of this equipment.
- The product shall be disconnected from its power source during service and when replacing parts.
- Maintenance and repair must be performed by trained service personnel only. Improper maintenance would not only damage the machine, but also may present a danger to the exerciser.
- Keep this product out of use until maintenance is completed.
- If you need to remove the cover for repair or maintenance, be sure to contact the service station or dealer to deal with, do not operate on their own.

## **MAINTENANCE** Error Messages

**ERROR\_1\_x, ERROR\_2\_x, ERROR\_3\_x, ERROR\_4\_x, ERROR\_5\_x and ERROR\_6\_x.**

Error messages will appear on the display as a troubleshooting aid when the Micro Inverter detects an abnormality.

Error code explanations:

<b>Error code</b>	<b>Explanation</b>
ERROR 1-1	Boot self-test error. (Zero voltage level anomaly for AC voltage)
ERROR 1-2	Boot self-test error. (Zero current level abnormality of AC current)
ERROR 3-1	AC power loss (The island effect).
ERROR 3-2	AC power supply voltage out of operating range.
ERROR 3-3	AC power frequency out of operating range.
ERROR 4-3	DC BUS voltage is too high. (440V - 450V)
ERROR 4-4	DC BUS voltage is too high. (Greater than 450V)
ERROR 6-1	Generator over current
ERROR 6-2	Generator over voltage.

For Error \_3\_1\_, the error message will be shown for 4 seconds, then return to the start screen. For other errors, the device will shut down and cannot be operated. Please turn off the power and follow the troubleshooting procedures to fix the error and resume normal operation.

### **ERROR\_8\_x**

Error messages will appear on the display when the Micro Inverter communication is abnormal.

Error code explanations are as follows:

<b>Error code</b>	<b>Explanation</b>
ERROR_8_1_	When power on, the communication to the console is abnormal.
ERROR_8_2_	When power on, the communication to the console is normal, however an abnormality occurs during operation

These two errors will disappear once the communication is recovered.

## MAINTENANCE Schedule

	Area	Day	Week	Month	Quarter	Year	Notes
1	Exterior	●					Cleanliness inspection
2	Screws	●					Inspect and secure loose parts
3	Saddle	●					Use a cloth moistened with water then wrung well, and wipe the saddle gently.
4	Pedals	●					Inspect and secure loose parts
5	Seat post		●				Cleaning and lubrication

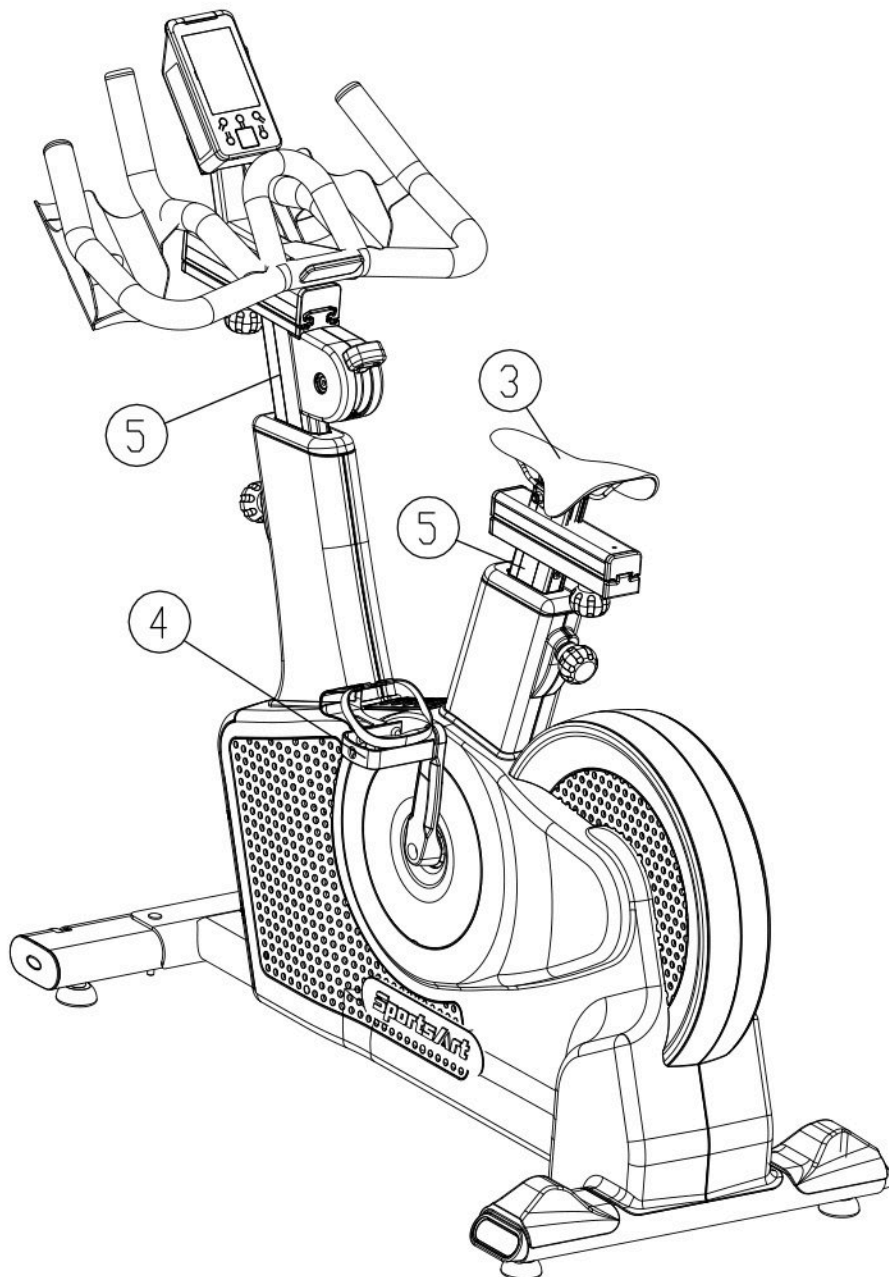

## **MAINTENANCE** Task List

---

Like cars, fitness products require maintenance. Regular maintenance extends product life, and failure to maintain products can void the manufacturer's warranty. Copy the maintenance log sheet, and record maintenance work for each fitness product.

### **Daily tasks**

1. Use a clean, lint-free towel to thoroughly clean the product exterior.
2. Inspect all screws. Secure if necessary.
3. Use a cloth moistened with water then wrung well, and wipe the saddle gently.
4. Inspect and secure loose parts

### **Weekly tasks**

Clean and lubricate the seat post.

### **Caution**

- Please follow standard safety precautions when servicing this product.
- Do NOT use cleaners with alcohol, ammonia, or other damaging chemicals. The use of such chemicals can damage the product and void the warranty. Never spray or pour any liquid directly onto the product. Doing so can damage components and void the warranty.

## **MAINTENANCE** Maintenance Log

Facility: \_\_\_\_\_ Supervisor: \_\_\_\_\_  
 Product model number: \_\_\_\_\_ Serial number: \_\_\_\_\_  
 Start date: \_\_\_\_\_ End date: \_\_\_\_\_

Daily Tasks	Week 1-7							Week 8-14							Week 15-21							Week 22-28									
Completed																															

Daily Tasks	Week 29-35							Week 36-42							Week 43-49							Week 50-52									
Completed																															

Weekly Tasks	Week 1-7							Week 8-14							Week 15-21							Week 22-28									
Completed																															

Weekly Tasks	Week 29-35							Week 36-42							Week 43-49							Week 50-52									
Completed																															

Monthly Tasks	1	2	3	4	5	6	7	8	9	10	11	12
Completed												

Quarterly Tasks	Quarter 1	Quarter 2	Quarter 3	Quarter 4
Completed				

Yearly Tasks	Year 1
Completed	

Notes: \_\_\_\_\_  
 \_\_\_\_\_

## **10. ACCESSORIES**

### **ACCESSORIES Standard**

---

#### **USB Port Uses**

- (1) Provides 5V/1A for charging of smart phone or other devices. However it is incompatible with Android tablets and 5V/2A devices. Check your tablet for compatibility before charging.
- (2) Install (or upgrade) the software.
- (3) User info/data transmission. (Only if the optional SA WELL+ had been purchased)

#### **CSAFE PORT**

Fully compatible with CSAFE (Communications Specification for Fitness Equipment) Protocol.

#### **QR code and NFC tag**

- a. Without SA WELL+ : Scanning the QR code and tapping the NFC tag will only display the SPORTSART website.
- b. With SA WELL+ : Using our SA WELL+ app, you can scan the QR code or tap the NFC tag on the console to connect your smartphone to the bike.

## ACCESSORIES Option

### SA WELL+ Member System

1. The SA WELL+ App. is designed specially by SportsArt to assist the user in managing their workout history. Be sure to download the app from the App Store or Google Play.
  2. Use USB Flash Drive for identification .
  3. Provide efficient and effective management of user info/ workout data.
- For more information on SA WELL+ Member System, please visit the website at [www.gosportsart.com](http://www.gosportsart.com)

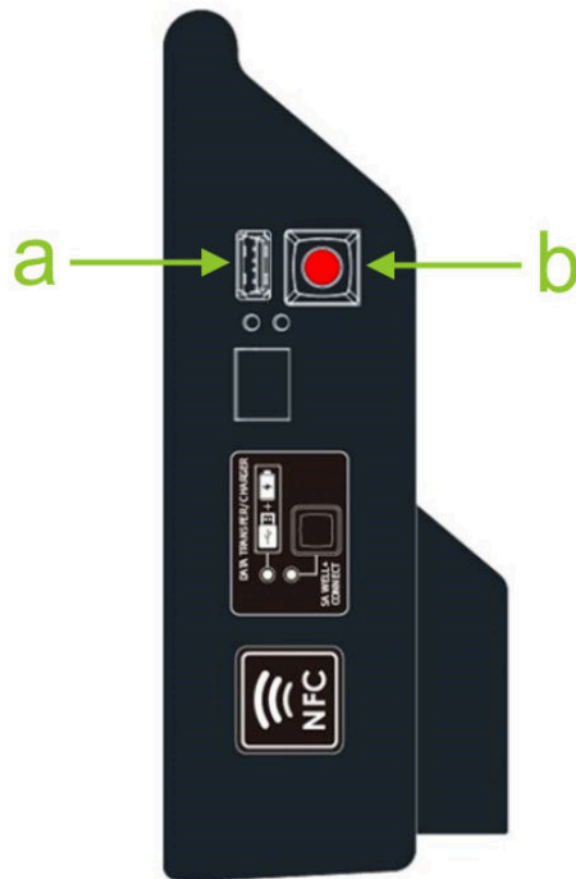

No.	Name of button	Function
a	USB port	Data transmission
b	Bluetooth/WIFI button	When a smartphone is connected wirelessly to the unit, press this button to disconnect. Scan the QR code or tap the NFC tag on the console if you want to reconnect the equipment again

**ACCESSORIES** Option (Cont.)

---

(1) ANTPLUS

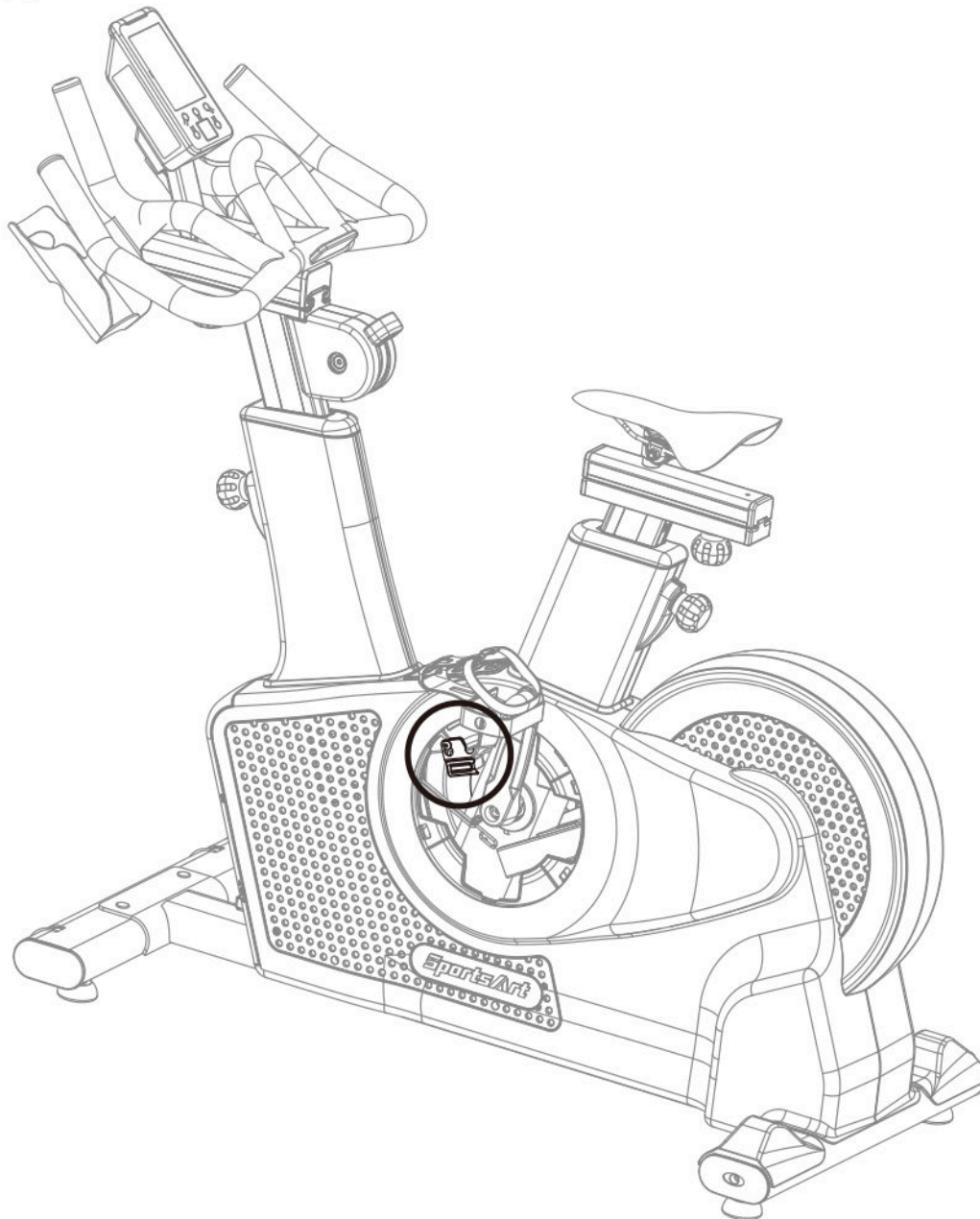

## 11. APPENDIXES

### APPENDIXES Technical Specifications

Model	G516
Dimensions	L : 1275mm (50.2" ) W : 546mm (21.5" ) H : 1185mm (44.7" )
Overall Weight	66kg (146 lbs)
Maximum User Weight	160kg (350lbs)
Power Requirement	100 - 120 V , 60Hz (USA) 200 - 240 V , 50Hz (EUROPE)
Circuit Breaker	125/250Vac , 3A

# APPENDIXES Wiring Diagram

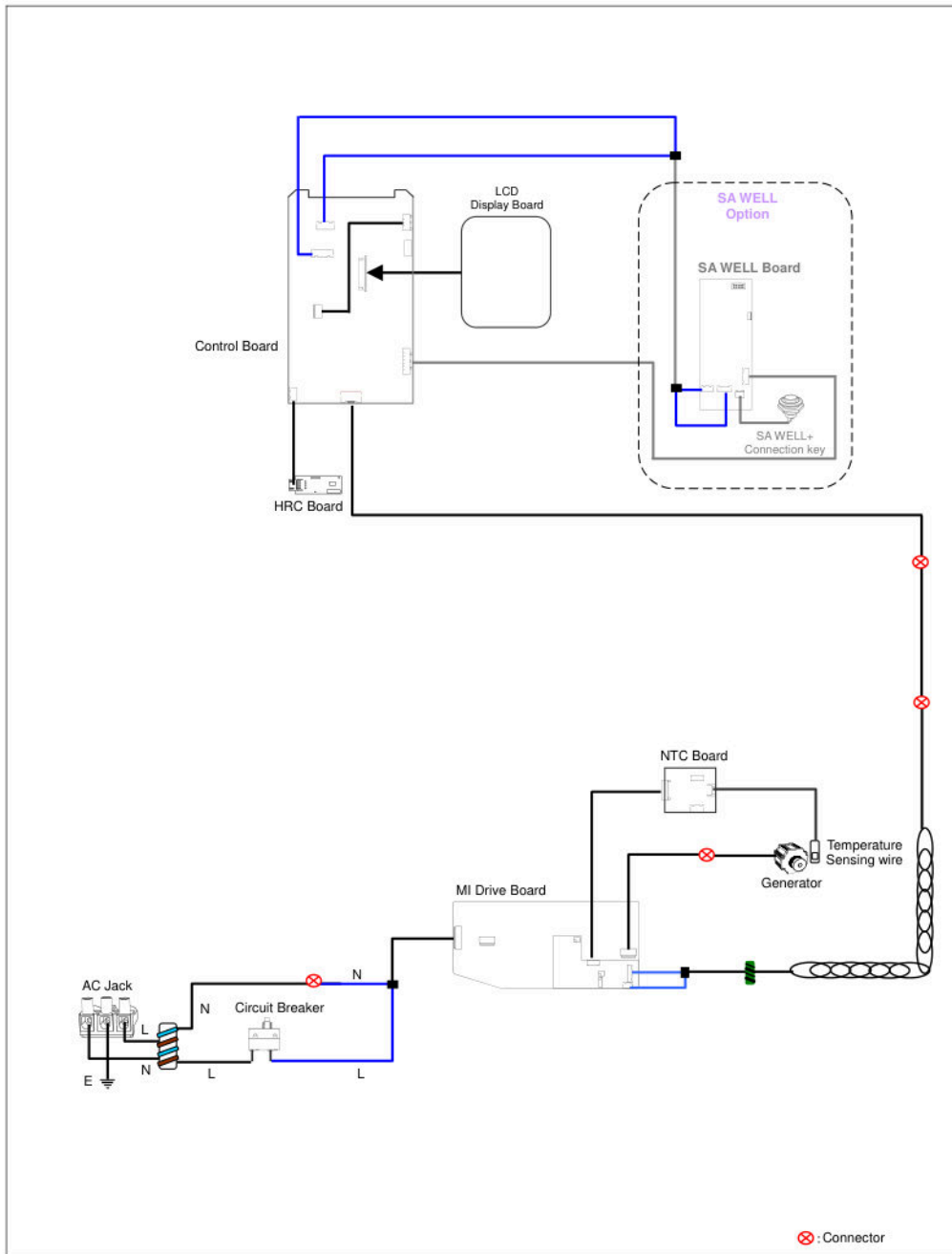

## **APPENDIXES** Exploded Diagram

---

Note: We reserve the right to revise the following diagrams at any time without notice to notify any person of such revisions. Please visit our official website [www.gosportsart.com](http://www.gosportsart.com) for the latest version.

## APPENDIXES Product Disassembly

Follow sequence of index numbers 1 through 7 assigned to the figure below to disassemble the product, and be sure to remove all the retaining screws before performing disassembly.

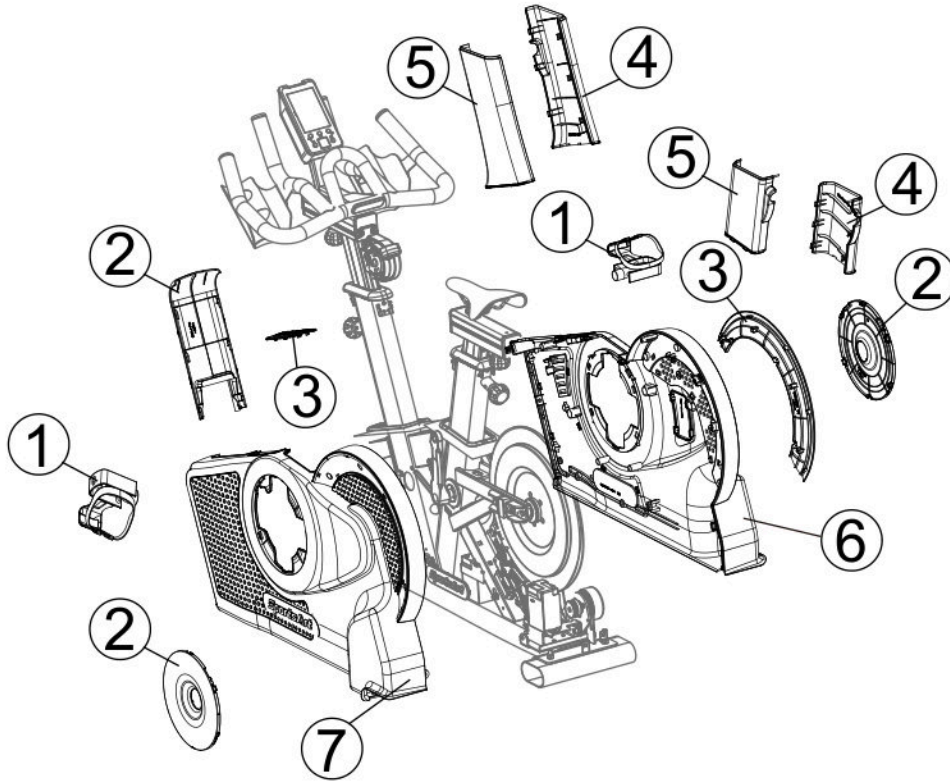

Your Authorized Distributor